

26<sup>th</sup> Annual

# Institute on Teaching and Mentoring

---

*Building Community for Academic Success*



## Program Agenda

October 24 – October 27, 2019

Atlanta Marriott Marquis

Atlanta, Georgia

# MOVING FORWARD TOGETHER

Kansas State University is dedicated to building an inclusive campus climate through leadership, communication and compassion. K-State is committed to making positive changes on campus and in the world around us.

Demonstrating an outstanding commitment to diversity and inclusion, Kansas State University has received the Higher Education Excellence in Diversity Award for five consecutive years.



“

“K-Staters have a collective responsibility to help build a community where everyone is welcome. Our goal is to graduate world-ready students who understand the power of inclusiveness.”

- President Richard Myers



**KANSAS STATE**  
UNIVERSITY



Download the K-State  
mobile app!

[k-state.edu](http://k-state.edu)



# Welcome to the 2019 Institute on Teaching and Mentoring

Hello everyone, and welcome to the 26th annual Institute on Teaching and Mentoring. The Institute planning committee and our many longtime supporting organizations are proud of this event, which helps so many scholars bolster their professional growth, successfully complete graduate school and prepare for college and university teaching positions.

The Institute is the nation's largest gathering of racial/ethnic minority Ph.D. scholars seeking faculty careers in academia. At the first Institute in 1994, there were only 107 attendees; this year we once again have nearly 1,000, including hundreds of Ph.D. students now in the pipeline. We especially want to welcome all the faculty mentors who accompany the scholars. Mentors play such an important role in the development of doctoral scholars, and faculty mentor participation is a unique component that contributes greatly to the experiences of those at the Institute.

Here at the Institute, you will find sessions for specific subjects and fields, sessions for groups, and sessions on many important topics that will contribute to your success in graduate school and the academy. These sessions are led by top professionals with skill sets from a variety of fields. We encourage you to select the sessions that will be most helpful to you. Arrive at those sessions early because they can fill up!

The theme for this year is *Building Community for Academic Success*. In your packets, you'll find a snapshot of a study funded by the National Science Foundation that shows the value that nearly 2,000 former Institute participants have placed on the Institute. We hope you're inspired and informed by the results.

The Institute continues to go green, so please download Guidebook, our conference "app" for this year. This app allows you to connect with fellow scholars, create your own schedule, see which faculty recruiters are here, and more. Our hope is that the app will help you to stay even more connected at this year's Institute.

We also want to express tremendous appreciation and thanks to the many organizations, agencies, institutions and staff members whose hard work makes this event possible. Please let us know how we can make the Institute even better for each of you, especially as we celebrate this 26th year and look to the future.



**INSTITUTE**  
on **TEACHING**  
and **MENTORING**

# Introduction

## The Issue

Minority students attain graduate degrees and enter academia at far lower rates than majority-group students. This means the contributions by people of color in academia and the professoriate are limited. This issue also has serious implications for all students whose educational experiences are enriched by diversity and for whom faculty members serve as influential mentors and role models.

## The Institute on Teaching and Mentoring

The Institute on Teaching and Mentoring addresses the minority faculty shortage by providing racial/ethnic minority students with information, encouragement and support to pursue doctoral degrees and become college professors. The Institute focuses on increasing the percentage of minority students who earn doctorates and helps diversify the pool of qualified candidates for faculty positions at colleges and universities. The Institute enables doctoral candidates to share insights and survival tips for success in graduate work, build community among themselves and faculty representatives, and enrich their research and teaching strategies. The Institute also benefits faculty members by helping them hone the mentoring skills that can assist them to create supportive departmental environments for underrepresented students.

## Save the Date for the 27<sup>th</sup> Annual Institute

October 29 - November 1, 2020 • Tampa, Florida • Marriott Water Street



## 4 Steps for Success at the Institute!

1. **Download Guidebook!** Search Guidebook in any mobile app store, and search for the 2019 Institute on Teaching and Mentoring Guide. Use the app to:
  - a. Access the schedule, session descriptions and speaker information.
  - b. Make a “Must Meet List” for colleagues and recruiters you want to connect with.
  - c. Sign up for any vacant CV review sessions.
  - d. See where recruiter institutions are located.
  - e. Plan your day in advance.
2. **Always be ready for a job offer!**
  - a. Dress for success! Look like the academic professional you are.
  - b. Always have your business cards accessible.
  - c. Have your pitch ready! Be ready to talk concisely about yourself and your interest.
  - d. Have your curriculum vitae handy. You never know when a recruiter will want to take the conversation further.
3. **Know the What, When and Where!**

Take note of the times of any mandatory meetings for your specific group.
4. **Use your voice to keep the Institute going!**
  - a. Complete evaluation forms. Your feedback helps us to make each Institute better than the last.
  - b. Note session codes in the agenda/Guidebook app for session evaluations.
  - c. Introduce yourself to your local, state or program representatives in attendance. Your voice of appreciation goes a long way to show that the Institute is needed.

guidebook

2019 Institute on Teaching and Mentoring

<https://guidebook.com/g/2019otm/>



- Visit the above URL on your device.
- Tap the “download” button to get the free Guidebook app.
- Open Guidebook and look for the guide **2019 Institute on Teaching and Mentoring**.

# Institute on Teaching and Mentoring

## Evaluation Instructions

We value your feedback! Receiving your completed evaluation form is the only way we can record and quantify your Institute experience. Providing feedback informs us of what works or does not work so that we are able to create a valuable overall Institute experience.

Please read through the instructions on completing individual workshop, plenary session and overall experience evaluations. Separate evaluations for faculty, administrators, staff and recruiters are provided.

### Concurrent Sessions

Fill out the paper scantron sheets provided at each session.

### Evaluations

- **Plenary Sessions and Overall Institute Evaluations**
- **Faculty/Administrators/Staff Evaluations**
- **Recruiter Evaluations**

If you have a smartphone/tablet device and Guidebook, you can access the evaluation form using the QR barcode below.

Use Guidebook to read the applicable **QR code**:

Open the Guidebook app and select the QR Reader on the app menu.

Scan the QR barcodes listed below.

If you need to access the codes after the sessions:

These codes can also be found on our Institute site —  
<http://www.instituteonteachingandmentoring.org/>

**Overall Institute Evaluation:**



**Faculty Evaluation:**



**Recruiter Evaluation:**



# **Scholar Directory**

## **A Tool for Networking and Recruiting**

The SREB-State Doctoral Scholars Program provides networking and recruiting opportunities through the Scholar Directory database. The database provides a platform for you to connect and network with other scholars who have participated in the Institute.

This tool is also useful for institutions to identify and recruit potential faculty. As an Institute attendee, you have been included in the database and have the opportunity to update and expand your profile with biographical, educational and employment information.

More than one hundred institutions have a one-year subscription to the Directory. This provides exposure for you and your doctoral peers to be recruited for positions on college and university campuses.

You never know when a career opportunity will arise. It is important for you to frequently update your Scholar Directory profile.

This is one of many ways that the Institute is assisting you and other minority Ph.D. scholars and graduates in attaining faculty careers.

**Check out the Directory this weekend!**

**<http://dspdirectory.sreb.org/>**



**Scan with your smartphone to be taken to the above website.**



# **The Institute on Teaching and Mentoring Acknowledges Institute Partners**

The goal of the Institute is to continue to increase the numbers of minority and underrepresented faculty in our nation's higher education academic institutions. The Institute strives to provide additional professional resources to Institute attendees that can assist them during their doctoral studies and as they transition into their academic professional careers. To meet this goal, SREB has a partnership with several organizations. These partnerships provide access to a wider network of professionals who can assist you as you grow and develop in your career.

## **Alfred P. Sloan Foundation Minority Ph.D. Program (MPHD)**

630 Fifth Avenue, Suite 2200

New York, NY 10111

(212) 649-1649

**[www.sloan.org](http://www.sloan.org)**

In the Sloan Minority Ph.D. program (MPHD), the Foundation partners with select faculty, departments and universities with proven track records of successfully recruiting and graduating minority Ph.D. candidates in STEM fields. Funds provide fellowships to minority students, allowing successful degree programs to enroll, train and eventually graduate more students than would otherwise be possible.

## **Gates Millennium Scholars Program (GMS)**

1805 7th Street NW

Washington, D.C. 20001

(877) 690-4677

**[www.gmsp.org](http://www.gmsp.org)**

The goal of GMS is to promote academic excellence and provide an opportunity for outstanding minority students with significant financial need to reach their highest potential. Established in 1999 by a \$1 billion grant from the Bill and Melinda Gates Foundation, the program provides support for the cost of education by covering unmet need and self-help aid: graduate school funding for continuing scholars in the areas of computer science, education, engineering, library science, mathematics, public health or science, and leadership development programs with distinctive personal, academic and professional growth opportunities.

## **Higher Education Recruitment Consortium (HERC)**

**[www.hercjobs.org](http://www.hercjobs.org)**

HERC is a nonprofit consortium of over 600 colleges and universities seeking to recruit and retain the most talented and diverse faculty, staff and executives. The partnership encourages you to utilize its excellent free resources for your academic job search process: access to more than 21,000 higher education job opportunities, webinars, a jobseeker blog, and many more helpful tools.

### **National Aeronautics and Space Administration Harriett-Jenkins Predoctoral Fellowship Project (JPFP)**

NASA Ames Research Center, Mail Stop 226-8

Moffett Field, CA 94035-1000

(650) 604-5000

**[www.nasa.gov](http://www.nasa.gov)**

The Jenkins Predoctoral Fellowship Project is supported by NASA. The program seeks to increase the number of graduate degrees awarded to underrepresented persons (women, minorities and persons with disabilities) in the science, technology, engineering and mathematics, or STEM, disciplines. The ultimate goal is to increase the U.S. talent pool by developing a more inclusive, multicultural and sustainable STEM workforce. The JPFP provides up to three years of support and includes a Mentor-Protégé Initiative, a Fellows Orientation, a Technical Exchange Symposium and the competitive Mini Research Award Program.

### **National Center for Faculty Development & Diversity**

2885 Sanford Ave. SW, Suite 27580

Grandville, MI 49418

(313) 347-8485

**[www.facultydiversity.org](http://www.facultydiversity.org)**

The National Center for Faculty Development and Diversity is a community of 40,000 graduate students, post-docs and faculty members who support each other through professional development opportunities, training and mentoring. The organization offers on-campus workshops, professional development training, and intensive mentoring programs to those who join.

### **SREB-State Doctoral Scholars Program (SREB)**

592 10th St. N.W.

Atlanta, GA 30318-5776

(404) 875-9211

**[www.sreb.org](http://www.sreb.org)**

The Southern Regional Education Board developed the Doctoral Scholars Program in 1993 to address the shortage of minority Ph.D. students in faculty positions. The Doctoral Scholars Program provides multiple layers of support including financial assistance, academic/research funding, career counseling and job postings, scholar counseling and advocacy, a scholar directory for networking and recruiting, invitation to the annual Institute on Teaching and Mentoring, and continued early career support.





# 2019 Institute Agenda at a Glance

All scholars should attend activities shown below in **bold**.  
See the “Agenda in Detail” for sessions that are **REQUIRED** or recommended for your scholar group.  
Curriculum/Vitae Review (CV) Sessions will be available daily. See schedule at registration desk.

**All sessions are at the Marriott Marquis, Atlanta, Georgia**

<u>Day/Date</u>	<u>Time</u>	<u>Activity</u>	<u>Page</u>
<b>Thursday, October 24</b>			
	Noon - 8 p.m.	<b>Registration and Check-In</b>	31
	2 - 9 p.m.	Networking Break/Faculty Recruiting Station Visits	31
	5:30 - 6:30 p.m.	<b>Orientations by Group — REQUIRED for ALL scholars</b>	31
	7 - 8 p.m.	<b>Welcome (light refreshments, dinner on your own)</b>	33
	8 - 9 p.m.	Chalk Talk Training Session (for Chalk Talk presiders)	33
	8 - 9 p.m.	<b>Orientation for Institutionally Funded SREB Scholars — Required</b>	33
<b>Friday, October 25</b>			
	7 - 8:30 a.m.	<b>Breakfast Group Meetings</b>	35
	7:30 a.m. - 12:15 p.m.	<b>Registration and Check-In</b>	25
	8:45 - 10:15 a.m.	<b>Welcome, Opening Session and Keynote Address</b>	36
	10:15 - 11 a.m.	Networking Break/Faculty Recruiting Station Visits	36
	11 a.m. - 12:15 p.m.	<b>Concurrent Interest Group Sessions or CV Reviews</b>	37
	12:30 - 2 p.m.	<b>Meet and Greet Luncheon and Plenary Session I</b>	38
	2 - 2:45 p.m.	Networking Break/Faculty Recruiting Station Visits	38
	2 - 4 p.m.	<b>Registration and Check-In</b>	38
	2:45 - 4 p.m.	<b>Concurrent Interest Group Sessions or CV Reviews</b>	38
	4 - 5:15 p.m.	Networking Break/Faculty Recruiting Station Visits	39
	5:15 - 5:30 p.m.	<b>Recruiters Photos</b>	40
	5:30 - 7:30 p.m.	<b>Institute Graduates' Awards Banquet</b>	40
<b>Saturday, October 26</b>			
	7 - 8 a.m.	<b>Chalk Talks and Networking Breakfasts by Discipline</b>	41
	7:30 a.m. - 12:45 p.m.	<b>Registration and Check-In</b>	41
	8:15 - 9:30 a.m.	<b>Plenary Session II</b>	42
	9:30 - 10:15 a.m.	Networking Break/Faculty Recruiting Station Visits	42
	10:15 - 11:30 a.m.	<b>Concurrent Interest Group Sessions or CV Reviews</b>	42
	11:45 a.m. - 1 p.m.	<b>Concurrent Interest Group Sessions</b>	44
	1 - 2:30 p.m.	<b>Luncheon and Awards Program</b>	45
	2:30 - 3 p.m.	Networking Break/Faculty Recruiting Station Visits	45
	2:30 - 4 p.m.	<b>Registration and Check-In</b>	46
	3 - 4 p.m.	<b>Group Photos</b>	46
	4 p.m.	Free time (Dinner is on your own.)	46
<b>Sunday, October 27</b>			
	8 - 9:30 a.m.	<b>NSF/STEM Fellowships Boot Camp One-on-One Consultation Sessions</b> (Required for NSF/STEM participants)	47
	8:15 - 9:30 a.m.	<b>NASA Scholars Meeting with NASA Representatives</b>	47
	8:15 - 9:30 a.m.	<b>Undergraduate Session III: Grants and Fellowships 101: Who, What, When, How —</b>	47
	8:30 - 9:45 a.m.	<b>Closing Session for Sloan Scholars, UCEM Leaders and MPhD</b>	47
	9:45 - 11:30 a.m.	<b>Brunch and Closing Session</b>	47
	11:30 a.m. - Noon	<b>Adjournment</b>	47

# Meeting Room Maps

## Atrium Level (AL)

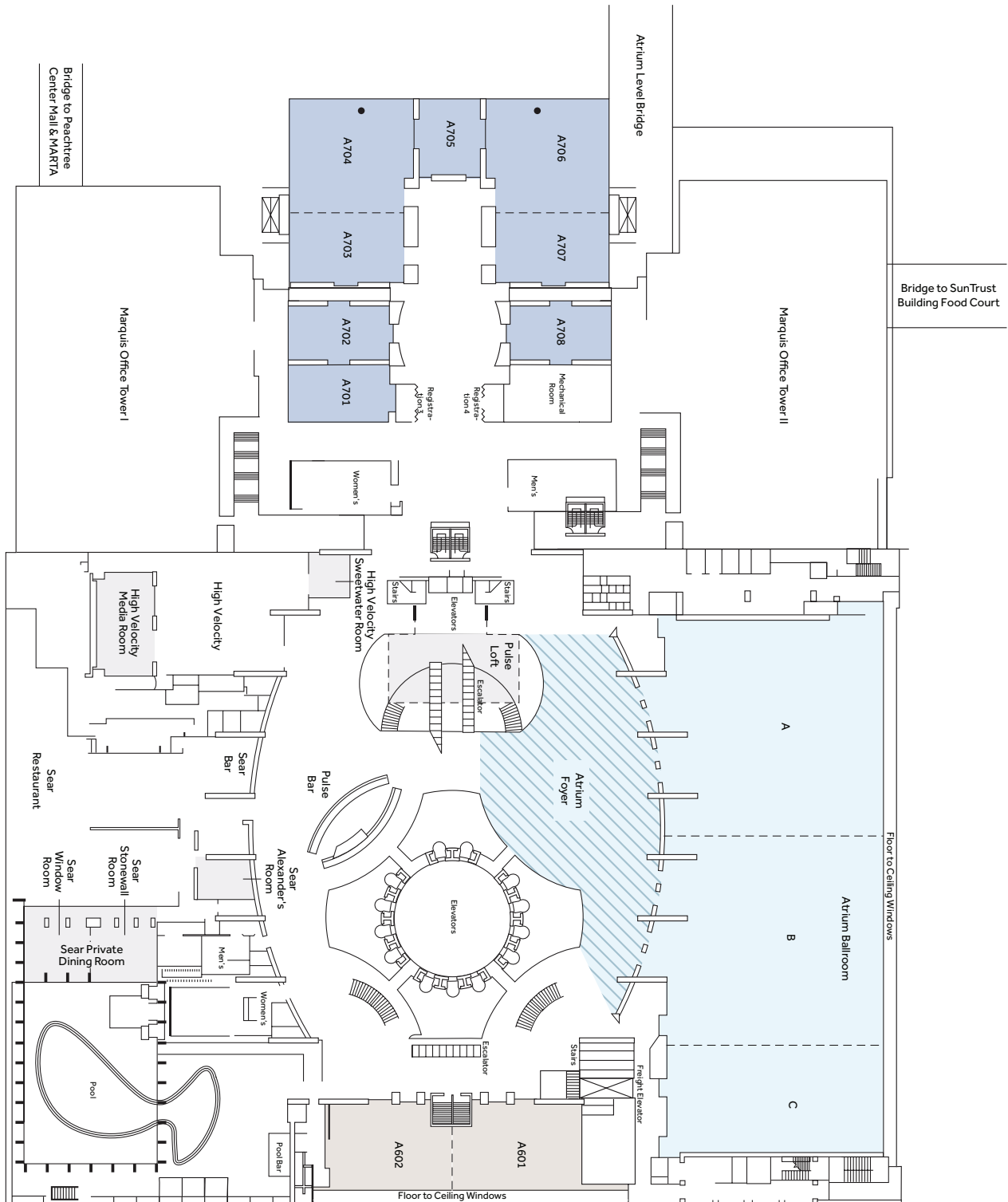

## Lobby Level (LL)

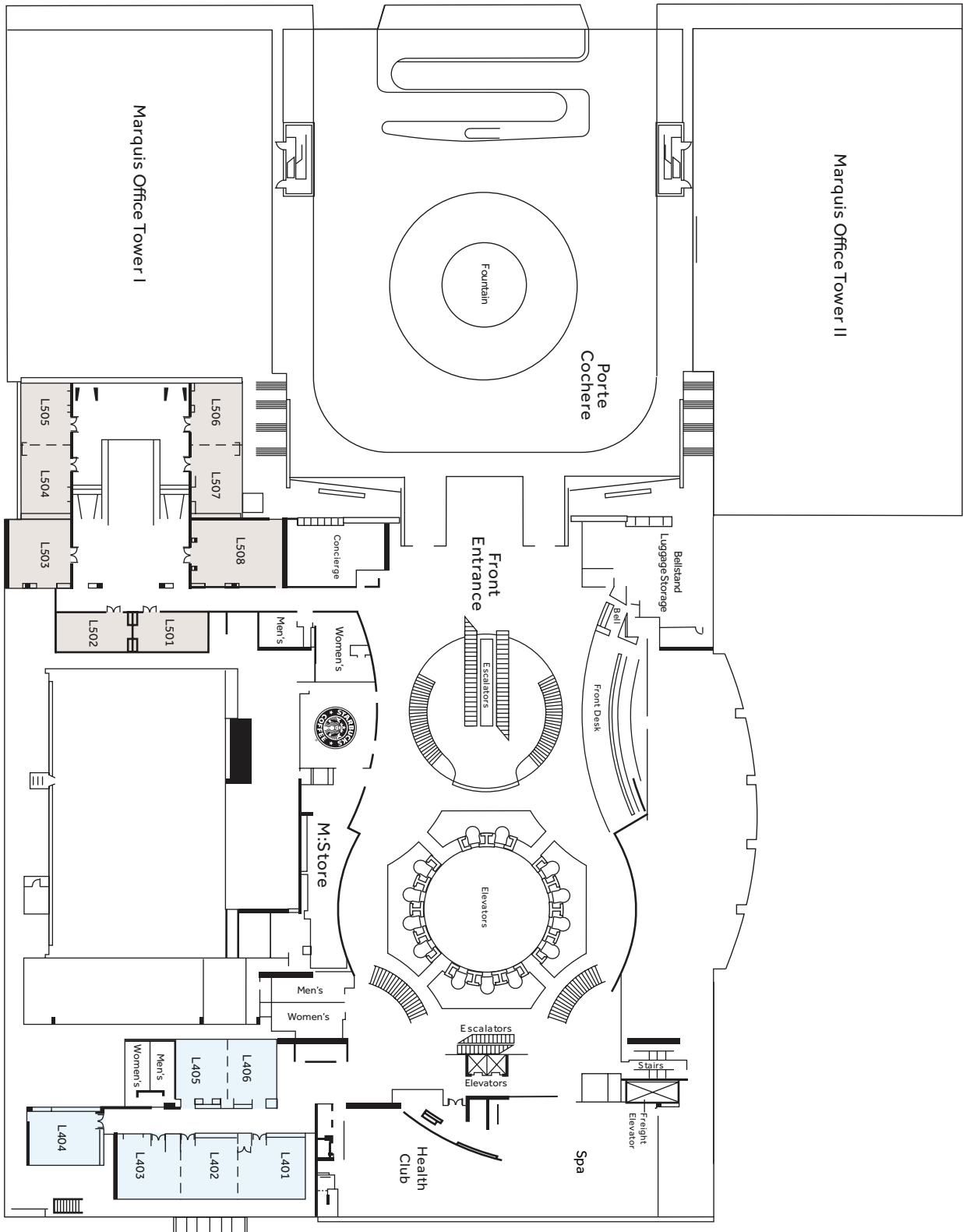



# Meeting Room Maps

## Marquis Level (ML)

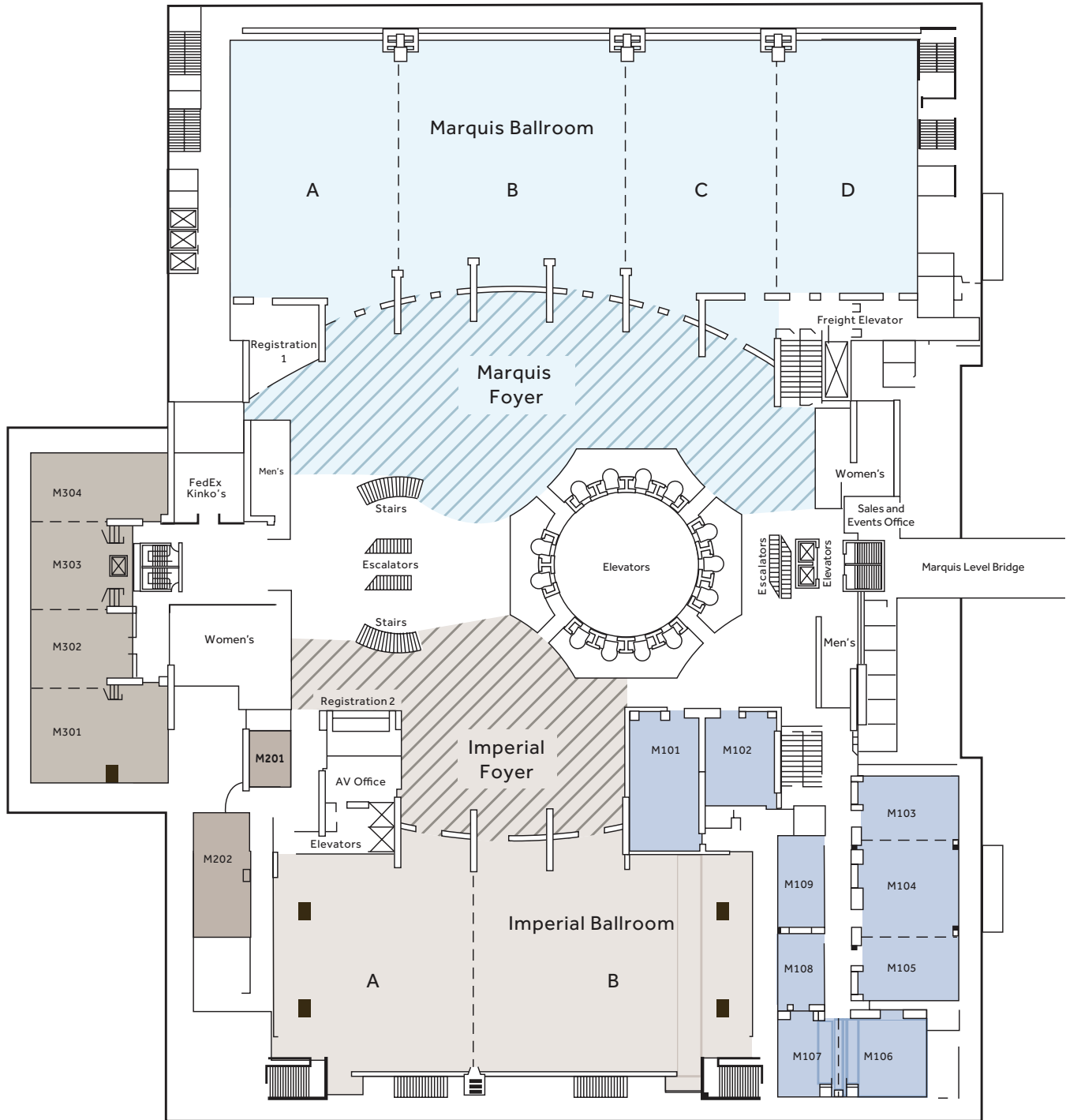

# Recruiter Institutions and Table Numbers

Auburn University (86) Auburn, AL	Framingham State University (59) Framingham, MA	North Carolina State University (109) Raleigh, NC
Augustana College (110) Rock Island, IL	George Mason University (68) Fairfax, VA	Northeastern University (28) Boston, MA
Bard Early College (39) Annandale-on-Hudson, NY	Higher Education Recruitment Consortium-HERC (16) Santa Cruz, CA	Northern Kentucky University (107) Highland Heights, KY
Belmont University (7) Nashville, TN	Hope College (20) Holland, MI	Northwestern University (111) Chicago, IL
Bentley College (40) Waltham, MA	Indiana University-Purdue University Indianapolis (74) Indianapolis, IN	Ohio State University, Columbus (72 & 73) Columbus, OH
Birmingham Southern College (60) Birmingham, AL	Indiana University-Kokomo (22) Kokomo, IN	Ohio University (92) Athens, OH
Bloomsburg University of Pennsylvania (89) Bloomsburg, PA	Indiana University, Bloomington (31) Bloomington, IN	Old Dominion University (44) Norfolk, VA
Boston University (41 & 42) Boston, MA	Ithaca College (3) Ithaca, NY	Oregon State University (80) Corvallis, OR
Bridgewater State University (21) Bridgewater, MA	Kansas City University of Medicine and Biosciences (78) Kansas City, MO	Pennsylvania State University (58) State College, PA
California State University – Northridge (71) Northridge, CA	Kent State University (62) Kent, OH	Philadelphia College of Osteopathic Medicine (57) Philadelphia, PA
California State University – Sacramento (87) Sacramento, CA	Loyola Marymount, Los Angeles (25) Los Angeles, CA	Purdue University at Lafayette (83) West Lafayette, IN
California University of Pennsylvania (56) California, PA	McNeese State University (32) Lake Charles, LA	Rochester Institute of Technology (85) Rochester, NY
Carnegie Mellon University (84) Pittsburg, PA	Medical University of South Carolina (37) Charleston, SC	Salem State University (6) Salem, MA
Case Western Reserve University (77) Cleveland, OH	Metropolitan Community College (101) Omaha, NE	San Jose State University (91) San Jose, CA
Clemson University (82) Clemson, SC	Michigan State University (23) East Lansing, MI	SUNY at Buffalo (53) Buffalo, NY
College of William and Mary (17) Williamsburg, VA	Middle Tennessee State University (8) Murfreesboro, TN	SUNY Buffalo State (103) Buffalo, NY
Creighton University (99) Omaha, NE	Missouri University of Science and Technology (66) Rolla, MO	SUNY Cortland (19) Cortland, NY
Duke University (81) Durham, NC	Mount Holyoke College (38) South Hadley, MA	SUNY Oswego (15) Oswego, NY
East Carolina University (29) Greenville, NC	Murray State University (33) Murray, Kentucky	SUNY Stony Brook (46) Stony Brook, NY
East Stroudsburg University (106) East Stroudsburg, PA	Nazareth College (54) Rochester, NY	Texas Christian University (102) Fort Worth, TX
East Tennessee State University (94) Johnson City, TN		Tuskegee University (79) Tuskegee, AL
Florida International University (27) Miami, FL		

## Recruiter Representatives and Table Numbers, *continued*

University of Alabama (51) Tuscaloosa, AL	University of Miami (43) Coral Gables, FL	University of Tennessee, Chattanooga (48 & 49) Chattanooga, TN
University of Alaska Anchorage (105) Anchorage, AK	University of Minnesota-Morris (24) Morris, MN	University of Texas at Austin, Jackson School of Geosciences (4) Austin, TX
University at Albany, SUNY (88) Albany, NY	University of Minnesota-Rochester (97) Rochester, MN	University of Texas at San Antonio (93) San Antonio, TX
University of Arkansas, Fayetteville (10) Fayetteville, AR	University of Mississippi (2) University, MS	University of Tulsa (9) Tulsa, OK
University of Central Arkansas (13) Conway, AR	University of Missouri-Columbia (96) Columbia, MO	University of Wisconsin-Madison (113) Madison, WI
University of Central Florida (104) Orlando, FL	University of Missouri-Kansas City (65) Kansas City, MO	University of Wyoming (1) Laramie, WY
University of Connecticut (35) Storrs, CT	University of Missouri-St. Louis (64) St. Louis, MO	Ursinus College (117) Collegeville, PA
University of Dayton (14) Dayton, OH	University of Nebraska-Lincoln (52) Lincoln, NE	Virginia Community College System (30) Richmond, VA
University of Florida (100) Gainesville, FL	University of Nebraska at Omaha (108) Omaha, NE	Virginia Polytechnic Institute and State University (76) Blacksburg, VA
University of Georgia (12) Athens, GA	University of New Hampshire (50) Durham, NH	West Virginia University (98) Morgantown, WV
University of Houston-Downtown (95) Houston, TX	University of New Mexico (34) Albuquerque, NM	Williams College (45) Williamstown, MA
University of Kentucky (18) Lexington, KY	University of North Florida (5) Jacksonville, FL	Winthrop University (47) Rock Hill, SC
University of Louisiana at Lafayette (75) Lafayette, LA	University of Rochester (90) Rochester, NY	Worcester State University (63) Worcester, MA
University of Maryland-Baltimore County (11) Baltimore, MD	University of South Florida (26) Tampa, FL	



# Recruiter Table Locations

## Marquis Level Foyer Ballroom and Meeting Rooms

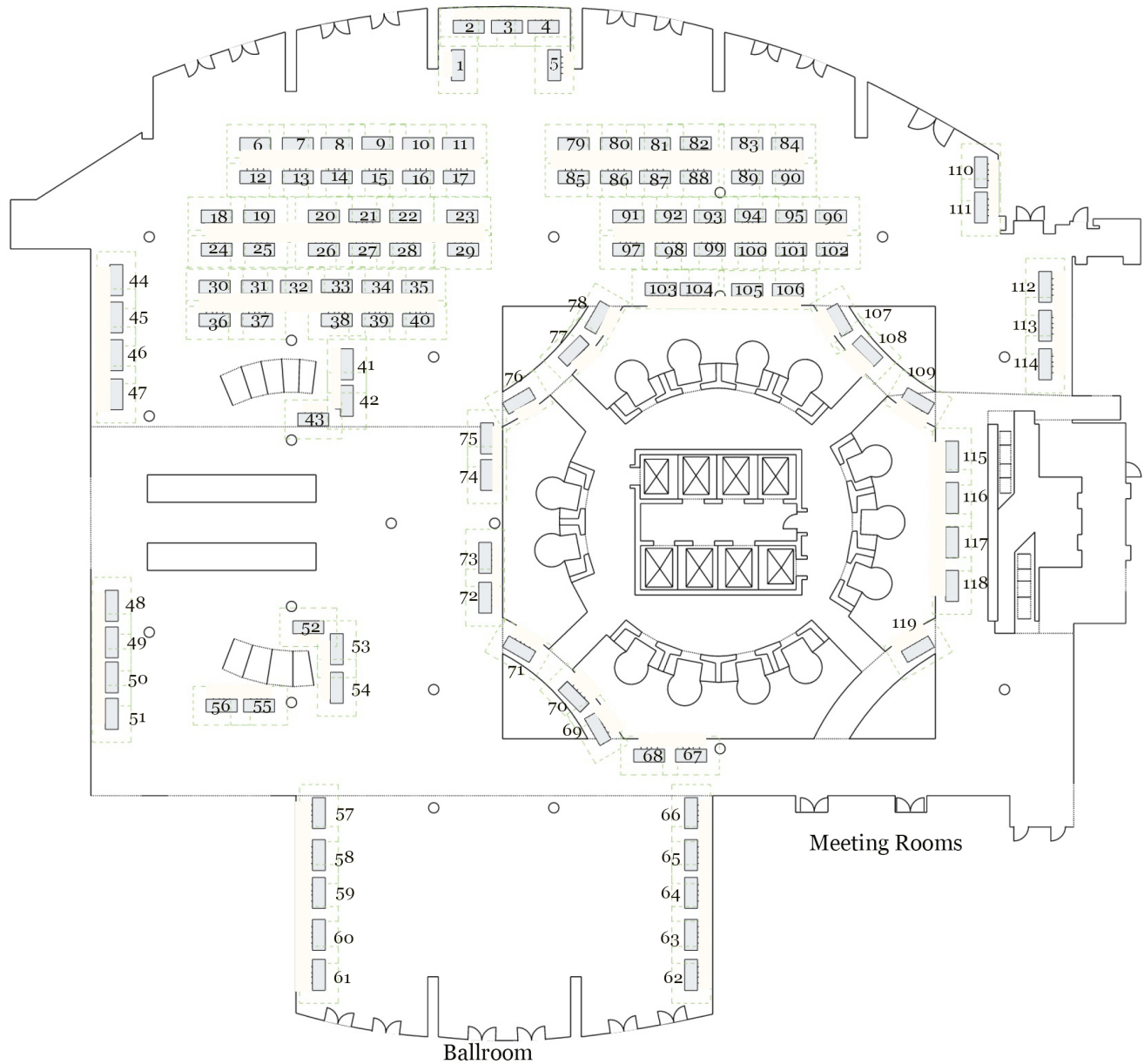

# Plenary Speakers

## Robert Belle

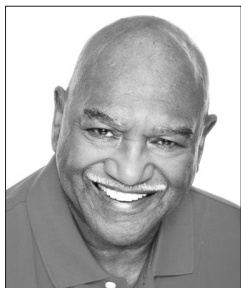

Dr. Robert (Bob) Belle was destined to be an educator. As the son and nephew of elementary teachers, Dr. Belle's career has included teaching experiences from elementary through graduate levels of education. Throughout his distinguished career, Dr. Belle has advocated for minority and underserved student access to opportunities in higher education. His numerous directorship positions include Upward Bound, Dropout Prevention, and Affirmative Action programs as well as the Office of Federal TRIO Programs and the Office of Minority Student Services. He has served as Tenured Associate Professor, Assistant Dean of Academic Affairs and Acting Assistant Deputy Secretary of Education.

A founding Associate Director of the SREB-State Doctoral Scholars Program, he continues to serve as Senior Consultant. Of his many awards, Dr. Belle is most proud of being an original inductee into the Glassboro Athletic Hall of Fame in 1986, his 2001 Frank Abbott Award for contributions to the Institute, his 2013 Walter O. Mason Jr. Award for contributions to TRIO, and his Rowan University Lifetime Service Award in 2016.

## Kamau Bobb



Dr. Kamau Bobb is the Global Lead for Diversity Strategy and Research at Google and the founding Senior Director of the Constellations Center for Equity in Computing at Georgia Tech. He is an engineer and science and technology policy scholar whose work focuses on the relationship between equity for students and communities of color in the STEM enterprise, large educational systems, and the social and structural conditions that influence contemporary American life. His wealth of experience includes former Program Officer at the National Science Foundation (NSF), where he helped shape the national research agenda for effective means of delivering equitable and quality computational education to all students. He has worked with members of the Office of Science and Technology Policy in the Obama Administration to set the national strategy for STEM education and was selected as a member of President Obama's My Brother's Keeper STEM + Entrepreneurship Taskforce to help U.S. cities craft strategies to engage young men and boys of color in the STEM landscape. Dr. Bobb holds a Ph.D. in Science and Technology Policy from Georgia Tech and M.S. and B.S. degrees in Mechanical Engineering from the University of California, Berkeley.

## Thelma Garcia



Dr. Thelma Garcia is the Newman Laboratory Research and Administrative Manager at the Buck Institute for Research on Aging in California. Her current research project involves maintaining a comprehensive research database of ketone body science. Her diverse range of publications includes topics in Stem Cell, CRISPR, Gold and Chromium. Besides serving as a hands-on Research Project Manager and assisting scientists while promoting multi-background awareness and effective cross-cultural and multidisciplinary communication in the lab, Dr. Garcia really enjoys being a mentor. She volunteers for the UC Davis FUTURE Career program, Sonoma County MESA Industry Alliance, and the MESA and STEM programs, as well as the Sonoma County Career Technical Education Foundation where she mentors High School Science Teachers. Dr. Garcia attended Santa Rosa Junior College, Sonoma State University and, later, UC Davis, where she completed doctoral studies in Chemistry. As a CDC-APHL postdoctoral fellow, Dr. Garcia's focus was in biochemistry/toxicology.

## Plenary Speakers, *continued*

### **Julio Hernandez**



Julio Hernandez serves as the Chief of Staff for the Division for Inclusion & Equity at Clemson University, where he provides analysis, recommendations and options to the Chief Diversity Officer on decisions to be made or problems to be resolved. Hernandez also provides leadership and support to the Vice Presidents and Associate Vice Presidents on inclusion and equity in recruiting, retaining and advancing Hispanic/Latinx students, staff and faculty, while fostering for them a welcoming, inclusive environment. In addition, Hernandez serves as the co-chair for Clemson University's Men of Color Summit, Brother-to-Brother Advisory Board, Global Leadership Institute Advisory Board, Clemson University Council for Diversity & Inclusion, President's Commission for Latino Affairs, and Staff Senator for both the President's and Board of Trustees budget center. Hernandez is a first-generation high school and college graduate with a bachelor's degree in International Business from the University of the Incarnate Word in San Antonio, Texas, and a master's degree in Management & Leadership from Webster University in Greenville. He is currently pursuing his doctorate in Educational Leadership with a focus in higher education.

### **Antentor Othrell Hinton Jr.**



Dr. Antentor Othrell Hinton Jr. is a Ford Foundation and Burroughs Wellcome Fund Postdoctoral Fellow at the University of Iowa, where he works in the laboratory of Dr. E. Dale Abel, the Chair and Departmental Executive Officer of Internal Medicine. He has been a passionate mentor for undergraduate students and has supported the careers of many undergraduates in Dr. Abel's laboratory. He has mentored 37 graduate and undergraduate students and has won two university-wide mentorship awards. In 2016, Dr. Hinton graduated from the Integrative Molecular and Biomedical Sciences Ph.D. Program at Baylor College of Medicine (BCM). Notably, he published two first author and 12 co-author publications during his time in Dr. Yong Xu's laboratory. He has won 26 career development, travel award, research award, oral and poster awards, and graduate fellowship awards. Before earning his doctorate, Dr. Hinton graduated from the Post Baccalaureate Research Education Program at BCM in 2010. He earned his bachelor's degree in biology at Winston-Salem State University.

### **Shirley Malcom**



Dr. Shirley Malcom is Senior Advisor and Director of SEA Change at the American Association for the Advancement of Science (AAAS). She has served as head of the AAAS Office of Opportunities in Science and as program officer in the Science Education Directorate of the National Science Foundation (NSF). Dr. Malcom received her doctorate in ecology from The Pennsylvania State University; her master's degree in zoology from the University of California, Los Angeles; and her bachelor's degree with distinction in zoology from the University of Washington. In addition, she holds seventeen honorary degrees. She serves on several boards, including The Heinz Endowments, and is an honorary trustee of the American Museum of Natural History, a Regent of Morgan State University, and a trustee of Caltech. She chairs the board of the National Math-Science Initiative and co-chairs the Gender Advisory Board of the UN Commission on Science and Technology for Development. In 2003, Dr. Malcom received the Public Welfare Medal of the National Academy of Sciences, the highest award given by the Academy.

## Plenary Speakers, *continued*

### **Stephen Pruitt**



Dr. Stephen Pruitt started his education career as a high school chemistry teacher in Fayetteville and Tyrone, Georgia. During his career, He has amassed an extensive policy, assessment and instructional background in education at the local, state and national levels. In May 2018, the Southern Regional Education Board unanimously voted to hire Dr. Pruitt as President. Prior to this appointment, Dr. Pruitt served as Kentucky's sixth Commissioner of Education, Senior Vice President for Achieve, Inc., and President of the Council of State Science Supervisors. A native of Georgia, Dr. Pruitt holds a bachelor's degree in chemistry from North Georgia College and State University, a master's degree in science education from the University of West Georgia and a Ph.D. in chemistry education from Auburn University.

# *Thank You*

We would like to acknowledge and thank partnering institutions  
for their contribution and support of the

## *26th annual Institute on Teaching and Mentoring*

Sponsors include:

SILVER

\$4,000

**Indiana University-Purdue University Indianapolis**

**Ohio State University**

**Old Dominion University**

**University of New Hampshire**

**Virginia Commonwealth University**

BRONZE

\$3,000

**University of Mississippi**

**University of Tennessee, Knoxville**

COPPER

\$2,000

**Mississippi State University**

**Philadelphia College of Osteopathic Medicine**





**B**entley University is more than just one of the nation's top business schools. We're a transformative living-learning community that prepares ethical students to use their business know-how to make a positive difference in the world. With a blend of business, technology and the arts and sciences, we provide students with critical thinking and practical skills to help them collaborate effectively in different settings and prepare them to lead successful, rewarding careers. The university is committed to building a community of talented students, faculty and staff who reflect the diversity of global business. If you're interested in changing the world, we'd like to help.

We seek talented individuals who are committed to our mission of educating creative, ethical and socially responsible students who will become organizational leaders nationally and internationally. All members of our faculty and administrative staff play a critical role

in creating an inspiring, compassionate and inclusive community. We believe that a commitment to inclusive excellence plays an essential role in our educational mission by fostering greater innovation and creativity, attracting the widest pool of qualified applicants to our work force, and enhancing our communication and relationships with the community.

#### **Positions Available**

- Tenure Track Assistant Professor, Psychology
- Tenure Track Assistant Professor, Bioinformatics/Computational Biology
- Tenure Track Assistant Professor, French
- Tenure Track Assistant Professor, Comparative Public Policy/International Public Policy
- Tenure Track Assistant Professor, English and Media Studies
- Tenure Track Open Rank, Mathematical Science (3 openings)
- Lecturer, Environmental Science
- Lecturer, English and Media Studies



**Visit us at the conference to learn more about Bentley and our current open positions, or check us out online anytime at [bentley.edu/facultycareers](https://bentley.edu/facultycareers).**

Bentley University, 175 Forest Street, Waltham, MA 02452 USA

PDF9/19.AA.542.19





# EXCITE THE DREAM ODU

An innovative experience at one of the top universities in the nation!

- Tour our campus
- Meet our award-winning scholars
- Receive scholarly direction from industry experts
- Receive professional development
- *Travel to ODU, all expenses paid*
- Present your research to deans and department chairs

**VISIT US AT TABLE #44 FOR MORE INFORMATION**

Contact Information:  
Office of Faculty Diversity and Retention  
Academic Affairs  
Email: [facultydiversity@odu.edu](mailto:facultydiversity@odu.edu)  
[www.odu.edu/excite-the-dream](http://www.odu.edu/excite-the-dream)





# Framingham

---

## State University



Framingham State University is a vibrant comprehensive liberal arts institution located just 20 miles west of Boston, Massachusetts.

At Framingham State University, diversity and inclusive excellence are central to creating an environment in which our employees feel valued and can truly be successful. FSU values the diversity represented by individual differences as well as inclusion derived from active, intentional, and ongoing engagement with diversity. FSU strives for equity and equity-mindedness, promoting opportunities for historically underrepresented populations and a demonstrated awareness of and willingness to address equity issues.

FSU provides a culturally relevant education that includes a beautiful campus with 35 bachelor's degrees with 80 concentrations and 70 minors, 24 master degree programs, a highly personalized teaching environment, and unparalleled commitment to excellence in diversity and inclusion. Our undergraduate constituency is 36% percent students of color, 16% who identify at Latinx.

Framingham State University is honored to be a four-time recipient of the INSIGHT into Diversity prestigious Higher Education Excellence in Diversity (HEED) award. The HEED award is the only national recognition honoring colleges and universities that exhibit outstanding efforts and success in the area of diversity and inclusion throughout their campuses.

Visit <http://www.framingham.edu/careers> to learn more about employment opportunities at Framingham State University.

Members of underrepresented groups, people of color, women, veterans, persons with disabilities, and all persons committed to diversity and inclusive excellence are strongly encouraged to apply.

We will have a team of three academic deans recruiting at the conference for tenure-track and full-time temporary positions. Please stop by our table! We will have a current listing of all open positions.



# Take Your Next Bold Step

Loyola Marymount University, a nationally ranked, R2 university located in Silicon Beach, the innovation hub of Los Angeles, seeks ambitious faculty ready to shape our thriving academic community. Five hundred years of Jesuit tradition inform our mission to encourage learning and educate the whole person. Inclusive excellence and the building of a just society are our defining characteristics. LMU is an equal opportunity employer - women, persons of color, LGBTQ and gender-nonconforming individuals, people living with disabilities, and others with diverse life experiences and beliefs are encouraged to apply at **[jobs.lmu.edu](https://jobs.lmu.edu)**.

If you would like to receive notifications when applications are being accepted for new faculty positions, visit:

**[https://jobs.lmu.edu/interest\\_cards](https://jobs.lmu.edu/interest_cards)**



**Loyola  
Marymount  
University**



# **YOUR** PASSION FOR DISCOVERY **OUR** COMMITMENT TO DIVERSITY

AT OHIO STATE, A DIVERSE COMMUNITY  
OF PEOPLE AND IDEAS INSPIRES DISCOVERY

Our commitment to an environment that inspires innovative alliances across a breadth of disciplines and expertise, plus the ingenuity of our students and the global reach of our partners, support Ohio State faculty as they ask the questions that haven't been asked and address the problems that need to be solved.



Darryl B. Hood  
*Associate Professor  
Environmental  
Health Sciences*

Lyda G. Garcia  
*Assistant Professor  
Meat Science*

Maryam Ghazisaeidi  
*Assistant Professor  
Computational  
Materials Science*

Deena Chisolm  
*Associate Professor  
Health Services  
Management and Policy*



**THE OHIO STATE UNIVERSITY**

LEARN ABOUT OUR COMMITMENT  
TO DIVERSITY AT OHIO STATE

Visit [oaa.osu.edu/diversity](http://oaa.osu.edu/diversity)



# **You're Invited!**

## **Faculty Recruitment Reception**

Saturday, October 26 | 4 P.M. - 6 P.M.

Room M102, Atlanta Marriott Maquis

---

Stop by to discover all that RIT offers

- Meet with RIT faculty, recruiters and administrators
- Explore current and anticipated faculty openings
- Learn about our Future Faculty Career Exploration Program
- Tell us about your research and career aspirations

We are especially interested in speaking with exceptional scholars in

**Business | Humanities | Science | Technology | Engineering | Computing  
Mathematics | Liberal Arts**

**Stop by table 85 and let us know if you are coming!**

### **FOR MORE INFORMATION**

[rit.edu/ofr](http://rit.edu/ofr)

### **CURRENT FACULTY OPENINGS**

[careers.rit.edu/faculty](http://careers.rit.edu/faculty)

### **GET SOCIAL**



[@RIT.OFDR](https://www.facebook.com/RIT.OFDR)



[@FacultyRecruit](https://twitter.com/FacultyRecruit)

**RIT** | Division of Diversity and Inclusion  
**Office of Faculty  
Diversity and Recruitment**



# UW CELEBRATES:

The Office of Diversity, Equity, and Inclusion established July 2017

A University of Wyoming Strategic Plan for Diversity, Equity, and Inclusion 2017-2022

11 years of operation for the Social Justice Research Center

17 years of the Rev. Dr. Martin Luther King Jr. Days of Dialogue and the Willena Stanford Commitment to Diversity Award

21 years of the Shepard Symposium on Social Justice

Thriving Colleges of Agriculture and Natural Resources, Arts and Sciences, Business, Education, Engineering and Applied Science, Health Sciences, and Law, as well as the Schools of Culture, Gender, and Social Justice, Energy Resources, and the Haub School of Environment and Natural Resources - and a graduate assistantship program that supports diverse and underrepresented students.

***\*At the UW table, visit with representatives from selected College of Arts and Sciences hiring departments***



LEARN ABOUT THESE AND OTHER GREAT OPPORTUNITIES FOR DIVERSE AND UNDERREPRESENTED POPULATIONS  
TO STUDY, RESEARCH, WORK, AND LIVE IN WYOMING: [UWYO.EDU/DIVERSITY/TODAY](http://UWYO.EDU/DIVERSITY/TODAY)





# A UNIVERSITY OF OPPORTUNITIES.

The College of Communication, Fine Arts and Media  
is searching for individuals to join us in the following positions:

- Assistant Professor of Percussion
- Assistant Professor of Theatre Design
- Assistant Professor of Orchestral Studies
- Instructor of Journalism and Media Communication
- Assistant Professor of Multi-Media Journalism
- Instructor of Communication Studies (2 positions)

Apply at [unomaha.peopleadmin.com/postings/search](https://unomaha.peopleadmin.com/postings/search)

UNIVERSITY OF  
**Nebraska**  
Omaha



Weber Fine Arts Building | 6505 University Dr South | Omaha, NE 68182 | [cfam.unomaha.edu](https://cfam.unomaha.edu)

UNO is Nebraska's metropolitan university — a university with strong academic values and significant relationships with our community that transforms and improves life. UNO does not discriminate based on race, color, ethnicity, national origin, sex, pregnancy, sexual orientation, gender identity, religion, disability, age, genetic information, veteran status, marital status, and/or political affiliation in its programs, activities, or employment. UCFLITEMP1016

# BECOME A VCU RAM

[graduate.vcu.edu](http://graduate.vcu.edu)

## VCU GRADUATE SCHOOL

408 West Franklin Street  
Box 843051  
Richmond, VA 23284-3051



## OUR GRADUATE SCHOOLS AND PROGRAMS RANKED IN THE TOP 50

- 1st Fine Arts - Sculpture
- 1st Nurse Anesthesia
- 2nd Fine Arts
- 3rd Education - Online
- 3rd Fine Arts - Glass
- 4th Rehabilitation Counseling
- 4th Rehabilitation Counseling
- 5th Health Care Management
- 7th Fine Arts - Graphic Design
- 7th Fine Arts - Painting/Drawing
- 9th Fine Arts - Ceramics
- 10th Fine Arts - Printmaking

The Virginia Commonwealth University Graduate School is committed to creating an environment that promotes diversity, equity and inclusiveness among the University's graduate programs, graduate faculty and graduate students. Master's and doctoral degree programs at VCU encompass a broad array of disciplines from the arts to science, technology, engineering and mathematics to the social sciences. Graduate students and faculty from diverse cultural backgrounds with different experiences and perspectives working together are better equipped to solve complex regional, national and global challenges.





## WORK. LIFE. BALANCE.

A mainstay on the U.S. News & World Report list of the country's top public universities for more than a quarter-century, Auburn is an exceptional institution. The university's spirit and personality play a starring role in our community, a town Southern Living hails as one of the South's most charming.

*Join us.*



## HARVARD GRADUATE SCHOOL OF EDUCATION

### **Faculty Search: Bluhm Family Assistant/Associate Professor of Data Science and Education**

The Harvard Graduate School of Education (HGSE) invites applications for a full-time faculty position in the area of data science and education. The appointment will be at the rank of tenure-track Assistant or Associate (untenured) Professor, depending upon experience.

We seek a candidate whose work aims to advance the application of data science to improve teaching, learning, and decision-making processes in education. Such work may include, for example, developing methodologies for analyzing complex data in ways that inform educational policies and practices, using machine learning to model treatment variation in large-scale experiments or observational studies, applying data science techniques to nonstandard educational data sources such as text corpora or event logs from online systems, or synthesizing complex data systems to compare multiple entities such as school districts across states. This list is not exhaustive, but illustrates how competitive candidates may demonstrate their commitment to advancing applications of data science to understand and improve education.

## Ready for your next step?

### So are we.

With more than 140 graduate programs designed to provide students with research opportunities and faculty mentorship, you'll find an intellectually stimulating environment for students and faculty. Join an academic home filled with a diverse, intimate community of scholars at **The University of Mississippi** — the state's flagship university.

Learn more: [careers.olemiss.edu](https://careers.olemiss.edu)  
and [gradschool.olemiss.edu](https://gradschool.olemiss.edu)



THE UNIVERSITY OF MISSISSIPPI | GRADUATE SCHOOL

## ***OPPORTUNITY, GROWTH AND SUNSHINE***

At UCF, our faculty are supported through a variety of offices and opportunities aimed at helping them achieve more. More chances to expand curious minds. More resources to pursue cutting-edge research. And more technology to stay at the forefront of an ever-changing world. Plus, Orlando's sunshine and economic growth create a perfect environment to live, work and explore.

To begin your career at UCF, visit [ucf.edu/faculty](https://ucf.edu/faculty).



## *Postdoctoral Diversity and Innovation Scholars*



looking for a  
unique postdoc  
experience?

### **The Postdoctoral Diversity and Innovation Scholars**

a professional development opportunity at a Research 1 university that builds a foundation for your academic career and enhances the diversity & excellence of our campus community

learn more and see if your field is available at:

[unh.edu/diverse-postdoc](http://unh.edu/diverse-postdoc)



**University of New Hampshire**  
Postdoctoral Diversity and  
Innovation Scholars

### **the two year professional development experience:**

- a cohort of diverse postdoctoral scholars pursuing independent research
- a research mentor, scholarly coach, external mentor, department ambassador
- the **UNH Writing Academy**
- the **UNH Research & Engagement Academy**
- teach one class annually & expand your pedagogical knowledge
- participate in the life of your department
- \$50,000 per year (minimum) & professional development funds

kindly forward this info card to possible candidates

**Now accepting applications until  
November 30, 2019**

# Agenda in Detail

*Institute 2019*

## Thursday, October 24

Noon - 8 p.m.      **REGISTRATION AND CHECK-IN**      **Imperial Foyer**

2 - 9 p.m.      **Networking/Faculty Recruiting Station Visits**      **Marquis and Imperial Foyers**  
*(Faculty recruiting stations are open until Saturday. Scholars are encouraged to visit.)*

### **ORIENTATION SESSIONS BY GROUP**

4 - 5 p.m.      **NSF/STEM Fellowships Boot Camp Session 1: Orientation, Introduction to STEM Fellowships (Open to all Institute attendees and required for NSF/STEM participants)**      **L508**

*Presiding: Michael Westrate*, Director, Center for Research and Fellowships, Villanova University, Villanova, PA

5 - 6:30 p.m.      **NSF/STEM Fellowships Boot Camp Session 2: The Gateway Grant Model, the NSF-GRFP, and Analyzing Models (Open to all Institute attendees and required for NSF/STEM participants)**      **L508**

*Presiding: Michael Westrate*, Director, Center for Research and Fellowships, Villanova University, Villanova, PA

5:30 - 6:30 p.m.      **Orientation for NASA Fellows and Scholars**      **M102**

*Presiding: Roosevelt Johnson*, Senior Advisor, Office of STEM Engagement, National Aeronautics and Space Administration (NASA), Washington, DC

*Presenter: Torry Johnson*, Manager, Minority University Research and Education Project (MUREP), NASA, Washington, DC

*Presenter: Erica J. Alston*, Deputy Manager, National Space Grant College and Fellowship Program (Space Grant), NASA Langley Research Center, Office of STEM Engagement, Washington, DC

*Presenter: Daesha Roberts*, Senior Specialist, Minority University Research and Education Project (MUREP), NASA Headquarters, Office of STEM Engagement, Washington, DC

*Presenter: Vandhana Lal*, NASA Fellowships Activity Manager, Minority University Research and Education Project (MUREP) and STEM Engagement Specialist, NASA Ames, Washington, DC

*Presenter: Dionne Hernandez-Lugo*, Deputy Manager, Kilopower Project, NASA Glenn Research Center, Washington, DC



## Thursday, October 24, *continued*

### ORIENTATION SESSIONS BY GROUP *continued*

- |                  |  |                              |
|------------------|--|------------------------------|
| 5:30 - 6:30 p.m. | <b>Orientation for SREB-State Doctoral Scholars and Faculty Representatives (Required)</b>   | <b>M103, M104 &amp; M105</b> |
|                  | <i>Presiding and Presenter: Ansley Abraham</i> , Director, SREB-State Doctoral Scholars Program, Southern Regional Education Board, Atlanta, GA  |                              |
|                  | <i>Presenter: Veda Overton-Houston</i> , Program Accounting and Grants Associate, SREB-State Doctoral Scholars Program, Southern Regional Education Board, Atlanta, GA                     |                              |
|                  | <i>Presenter: Monique Waddell</i> , Scholar Services Coordinator, SREB-State Doctoral Scholars Program, Southern Regional Education Board, Atlanta, GA                                     |                              |
|                  | <i>Presenter: Stevie L. Lawrence II</i> , Vice President, Postsecondary Education, Southern Regional Education Board, Atlanta, GA  |                              |
| 5:30 - 6:30 p.m. | <b>Orientation for Ronald E. McNair Postbaccalaureate Achievement Program and Student Support Services (SSS) Scholars and Directors (Required)</b>   | <b>M106 &amp; M107</b>       |
|                  | <i>Presenter: Samesha Barnes</i> , Director, McNair Scholars Program, University of Florida, Gainesville, FL   |                              |
| 5:30 - 6:30 p.m. | <b>Orientation for NSF Alliance for Graduate Education and the Professoriate Program Scholars (AGEP), NSF Social Behavioral Sciences Scholars, New England Scholars and Guest Scholars</b> | <b>M304</b>                  |
|                  | <i>Presenter: Belinda Anderson</i> , President (Retired), Virginia Union University, Richmond, VA  |                              |
| 5:30 - 6:30 p.m. | <b>Orientation for Gates Millennium Scholars Program Scholars and Faculty</b>  | <b>M101</b>                  |
|                  | <i>Presenter: Joakina Stone</i> , Relationship Manager, United Negro College Fund (UNCF) Gates Millennium Scholarship Program, Washington, DC  |                              |
| 5:30 - 6:30 p.m. | <b>Orientation for Alfred P. Sloan Minority Ph.D. (MPHD) Program Scholars, SLOAN Graduates, UCEM Leaders and MPHD Faculty (All Sloan)</b>  | <b>M302 &amp; M303</b>       |
|                  | <i>Presiding: Elizabeth S. Boylan</i> , Program Director, Alfred P. Sloan Foundation, New York, NY   |                              |
|                  | <i>Presenter: Calvin Howell</i> , Professor of Physics, Duke University, Durham, NC  |                              |
|                  | <i>Presenter: Jorge Calabria</i> , Research Assistant, University of South Florida, Land O' Lakes, FL  |                              |
|                  | <i>Presenter: Indira Turney</i> , Postdoctoral Research Scientist, Columbia University Irving Medical Center, New York, NY   |                              |
|                  | <i>Presenter: Sara Xayarath Hernandez</i> , Associate Dean for Inclusion and Student Engagement, Graduate School, Cornell University, Ithaca, NY   |                              |

## Thursday, October 24, *continued*

5:30 - 6:30 p.m.	<b>Orientation for Recruiters (Optional)</b> <i>Presenter: Rana Johnson</i> , Associate Vice President for Inclusive Excellence and Strategic Initiatives, Indiana State University, Terre Haute, IN	Marquis Salon A-C
6:45 - 8:15 p.m.	<b>Reception and Networking for Alfred P. Sloan Minority Ph.D. Scholars, Directors and Faculty</b> <i>Presiding: Elizabeth S. Boylan</i> , Program Director, Alfred P. Sloan Foundation, New York, NY <i>Presenter: Adam Falk</i> , President, Alfred P. Sloan Foundation, New York, NY <i>Presenter: Nate Williams</i> , Communications Manager, Alfred P. Sloan Foundation, New York, NY	Marquis Salon D
7 - 8 p.m.	<b>Welcome (light refreshments, dinner on your own)</b> <i>Presiding: Ken Pepion</i> , Higher Education Consultant, Durango, CO	Imperial Ballroom
7:30 - 8:30 p.m.	<b>NSF/STEM Fellowships Boot Camp Session 3: Writing a Successful Graduate Research Statement (Open to all Institute attendees and required for NSF/STEM participants)</b> <i>Presiding: Michael Westrate</i> , Director, Center for Research and Fellowships, Villanova University, Villanova, PA	L508
8 - 9 p.m.	<b>Chalk Talk Training Session</b> <i>Presenter: Antionette Denise Stroter</i> , Adjunct Professor, Director of Research & Evaluation, Liberty University, Lynchburg, VA	M108
8 - 9 p.m.	<b>Orientation for First-Year Institutionally Funded SREB Scholars (Required)</b> <i>Presiding and Presenter: Ansley Abraham</i> , Director, SREB-State Doctoral Scholars Program, Southern Regional Education Board, Atlanta, GA <i>Presenter: Veda Overton-Houston</i> , Program Accounting and Grants Associate, SREB-State Doctoral Scholars Program, Southern Regional Education Board, Atlanta, GA <i>Presenter: Monique Waddell</i> , Scholar Services Coordinator, SREB-State Doctoral Scholars Program, Southern Regional Education Board, Atlanta, GA	M304
8:30 - 9:30 p.m.	<b>NSF/STEM Fellowships Boot Camp Session 4: Writing a Successful Graduate Research Statement (Open to all Institute attendees and required for NSF/STEM participants)</b> <i>Presiding: Michael Westrate</i> , Director, Center for Research and Fellowships, Villanova University, Villanova, PA	L508



## Friday, October 25

7:30 a.m. - 12:15 p.m.	<b>REGISTRATION AND CHECK-IN</b>	<b>Imperial Foyer</b>
7 - 8:30 p.m.	<b>NSF/STEM Fellowships Boot Camp Session 5: Writing a Successful Personal (Relevant Background &amp; Future Goals) Statement (Open to all Institute attendees and required for NSF/STEM participants)</b>  <i>Presiding: Michael Westrate</i> , Director, Center for Research and Fellowships, Villanova University, Villanova, PA	<b>L508</b>
<b>BREAKFAST GROUP MEETINGS</b>		
7 - 8:30 a.m.	<b>Breakfast Meeting and Panel Discussion for NASA Fellows</b>  <i>Presiding: Erica J. Alston</i> , Deputy Manager, National Space Grant College and Fellowship Program (Space Grant), NASA Langley Research Center, Office of STEM Engagement, Washington, DC  <i>Presenter: Torry Johnson</i> , Manager, Minority University Research and Education Project (MUREP), NASA, Washington, DC  <i>Presenter: Mariel Friberg</i> , Postdoctoral Research Fellow, Postdoctoral Fellowship Program (NPP), Universities Space Research Association, NASA Goddard Flight Research Center, Washington, DC	<b>M102</b>
7 - 8:30 a.m.	<b>Breakfast Meeting for SREB-State Doctoral Scholars and Faculty Representatives (Required)</b>  <i>Presiding and Presenter: Ansley Abraham</i> , Director, SREB-State Doctoral Scholars Program, Southern Regional Education Board, Atlanta, GA  <i>Presenter: Monique Waddell</i> , Scholar Services Coordinator, SREB-State Doctoral Scholars Program, Southern Regional Education Board, Atlanta, GA  <i>Presenter: Stephen L. Pruitt</i> , President, Education Policies, Southern Regional Education Board, Atlanta, GA	<b>Marquis Salon A</b>
7 - 8:30 a.m.	<b>Breakfast Meeting for Sloan Scholars, UCEM Leaders and Faculty, SSMN Attendees and Facilitators (ALL SLOAN)</b>  <b>Topic: Establishing Your Professional Identity Part II:</b> <b>Table Discussion Leaders: Sloan graduates and facilitators in SSMN</b> <b>Closing Remarks: Deji Akinwande and Sara Xayarath Hernandez</b>  <i>Presiding: Alma Granado</i> , Program Officer, Sloan Scholars Mentoring Network, Social Science Research Council, Brooklyn, NY  <i>Presenter: Deji Akinwande</i> , David & Doris Lybarger Endowed Faculty Fellowship in Engineering, Professor, University of Texas at Austin, Austin, TX  <i>Presenter: Sara Xayarath Hernandez</i> , Associate Dean for Inclusion and Student Engagement, Graduate School, Cornell University, Ithaca, NY	<b>Marquis Salon D</b>

## Friday, October 25, *continued*

### BREAKFAST GROUP MEETINGS (continued)

7 - 8:30 a.m.	<b>Breakfast Meeting for McNair and SSS Scholars and Directors (Required)</b>	<b>M106 &amp; M107</b>
	<i>Presenter: Samesha Barnes</i> , Director, McNair Scholars Program, University of Florida, Gainesville, FL	
7 - 8:30 a.m.	<b>Breakfast Meeting for NSF (AGEP) Scholars, New England Scholars and Guest Scholars</b>	<b>M304</b>
	<i>Presenter: Belinda Anderson</i> , President (Retired), Virginia Union University, Richmond, VA	
7 - 8:30 a.m.	<b>Breakfast Meeting for Gates Millennium Scholars Program Participants (Required)</b>	<b>M101</b>
	<i>Presenter: Kelvin Harris</i> , Director of Leadership Development Programs and Alumni Relations, United Negro College Fund (UNCF) Gates Millennium Scholarship Program, Washington, DC	
7 - 8:30 a.m.	<b>Breakfast for Guests and Recruiters</b>	<b>Imperial Salon A</b>
8:45 - 10:15 a.m.	<b>WELCOME, OPENING SESSION AND KEYNOTE ADDRESSES</b>	<b>Marquis Ballroom</b>
	<i>Presiding and Presenter: Ansley Abraham</i> , Director, SREB-State Doctoral Scholars Program, Southern Regional Education Board, Atlanta, GA	
	<i>Presenter: Shirley Malcom</i> , Senior Advisor, American Association for the Advancement of Science, Center for Scientific Evidence in Public Issues, Washington, DC	
	<i>Presenter: Antentor Othrell Hinton Jr.</i> , Ford Foundation and Burroughs Wellcome Fund Postdoctoral Fellow, University of Iowa, Iowa City, IA	
	<i>Presenter: Thelma Y. Garcia</i> , Lab Research and Administrative Manager, Newman Lab, The Buck Institute, Novato, CA	
9 a.m. - 5 p.m.	<b>Recruiter Interviews (Optional)</b> <i>(Space available for recruiters to conduct interviews as needed)</i>	<b>A702</b>
10:15 - 11 a.m.	<b>Networking Break/Faculty Recruiting Station Visits</b>	<b>Marquis and Imperial Foyers</b>
	<i>(Faculty recruiting stations are open until Saturday. Scholars are encouraged to visit.)</i>	
10:30 a.m. - 12:15 p.m.	<b>NSF/STEM Fellowships Boot Camp Session 6: Writing a Successful Personal (Relevant Background &amp; Future Goals) Statement (Open to all Institute attendees and required for NSF/STEM participants)</b>	<b>L508</b>
	<i>Presiding: Michael Westrate</i> , Director, Center for Research and Fellowships, Villanova University, Villanova, PA	

## Friday, October 25, *continued*

### CONCURRENT INTEREST SESSIONS

11 a.m. - 12:15 p.m.	<b><i>Writing Your Dissertation (10)</i></b> <i>Presenter: David Schuldborg</i> , Professor of Psychology and Director of Clinical Training, University of Montana, Missoula, MT	<b>M103</b>
11 a.m. - 12:15 p.m.	<b><i>Tips for Writing Proposals (11)</i></b> <i>(Recommended for all disciplines)</i> <b>Wendy Carter-Veale</b> , Co-Founder, HigherEd Consulting Services LLC, Lewiston, NC	<b>M109</b>
11 a.m. - 12:15 p.m.	<b><i>Financial Planning for the Future: Investing Basics for Today's Market (12)</i></b> <i>Presenter: Steve Reznik</i> , Financial Advisor, Chiron Capital Management, Tallahassee, FL	<b>M102</b>
11 a.m. - 12:15 p.m.	<b><i>Undergraduate Session I: What to Do After You Apply to Ensure Admission and Funding (13)</i></b> <i>Presenter: Donald Asher</i> , Managing Partner, Asher Associates, Reno, NV	<b>M106 &amp; M107</b>
11 a.m. - 12:15 p.m.	<b><i>First and Lasting Impressions: Organizing for the Job Interview (14)</i></b> <i>Presenter: Rana Johnson</i> , Associate Vice President for Inclusive Excellence and Strategic Initiatives, Indiana State University, Terre Haute, IN	<b>M101</b>
11 a.m. - 12:15 p.m.	<b>FACULTY SESSION I: <i>Mentoring (15)</i></b> <i>Presenter: Stacy Blake-Beard</i> , Professor, Simmons School of Management, Boston, MA	<b>M304</b>
11 a.m. - 12:15 p.m.	<b><i>Teaching Session I: Current Trends in Culturally Relevant Teaching Methodologies as They Relate to Student Success ((16)</i></b> <i>Presenter: Jasmine Haywood</i> , Strategic Impact and Learning Officer, Lumina Foundation, Indianapolis, IN	<b>M104</b>
11 a.m. - 12:15 p.m.	<b><i>Curriculum Vitae (CV) Reviews I</i></b> <p>The Institute will offer CV review sessions again this year. If you signed up for a review and brought your CV or resume, you will receive a review by a recruiter. The review will give you immediate feedback on how to strengthen your CV or resume to stand out from others. Arrive early for your appointed time; you do not want to miss this unique opportunity to further your career in the academy.</p>	<b>A704</b>
11 a.m. - 12:15 p.m.	<b><i>The Business of Education: Structuring a Competitive Advantage (17)</i></b> <i>Presenter: Margaret Daniels Tyler</i> , Philanthropic Advisor/Educational Strategist, The Tyler Group, Affiliate of the Strategic Consulting Network, Boston, MA	<b>M105</b>

## Friday, October 25, *continued*

12:30 - 2 p.m.	<b>Meet and Greet Luncheon and Plenary Session I</b>	<b>Marquis Ballroom</b>
	<i>Presiding: Ansley Abraham</i> , Director, SREB-State Doctoral Scholars Program, Southern Regional Education Board, Atlanta, GA	
	<i>Presenter: Stephen L. Pruitt</i> , President, Southern Regional Education Board, Atlanta, GA	
	<i>Presenter: Robert L. Belle Jr.</i> , Senior Consultant, SREB-State Doctoral Scholars Program, Southern Regional Education Board, Atlanta, GA	
2 - 2:45 p.m.	<b>Networking Break/Faculty Recruiting Station Visits</b>	<b>Marquis and Imperial Foyers</b>
	<i>(Faculty recruiting stations are open until Saturday. Scholars are encouraged to visit.)</i>	
2 - 4:30 p.m.	<b>REGISTRATION AND CHECK-IN</b>	<b>Imperial Foyer</b>
	<b>CONCURRENT INTEREST SESSIONS</b>	
2:45 - 4 p.m.	<b><i>Networking for Personal and Professional Development: Managing Your Future in a Social Networking World (18)</i></b>	<b>M102</b>
	<i>Presiding and Presenter: Julia Hubbel</i> , President, The Hubbel Group Inc., Lakewood, CO	
	<i>Presenter: Jean Fuller-Stanley</i> , Associate Dean, College of Science and Health, and Professor of Chemistry, William Paterson University, Wayne, NJ	
2:45 - 4 p.m.	<b><i>Curriculum Vitae (CV) Reviews II</i></b>	<b>A704</b>
	The Institute will offer CV review sessions again this year. If you signed up for a review and brought your CV or resume, you will receive a review by a recruiter. The review will give you immediate feedback on how to strengthen your CV or resume to stand out from others. Arrive early for your appointed time; you do not want to miss this unique opportunity to further your career in the academy.	
2:45 - 4 p.m.	<b><i>Describing Your Research in Five Minutes or Less (19)</i></b>	<b>M103</b>
	<i>Presenter: Antionette Denise Stroter</i> , Adjunct Professor and Director of Research & Evaluation, Liberty University, Lynchburg, VA	
2:45 - 4 p.m.	<b><i>Getting Published: Advice for Scholars (20)</i></b>	<b>M109</b>
	<i>Presenter: Beth Luey</i> , Consultant, Beth Luey Consulting, Fairhaven, MA	
2:45 - 4 p.m.	<b><i>Developing Your Curriculum Vitae (21)</i></b>	<b>M302</b>
	<i>Presiding and Presenter: Harold Bibb</i> , Associate Dean (Retired), Graduate School, University of Rhode Island, Kingston, RI	
	<i>Presenter: David Schuldborg</i> , Professor of Psychology and Director of Clinical Training, University of Montana, Missoula, MT	



## Friday, October 25, *continued*

- |               |   |                                    |
|---------------|---|------------------------------------|
| 2:45 - 4 p.m. | <p><b><i>Solo Success: How to Thrive in Graduate School When You're the Only _____ in Your Department (22)</i></b></p> <p><i>Presenter: Joy Gayles</i>, Associate Professor, Higher Education Program Coordinator, North Carolina State University, Raleigh, NC</p>   | <b>M105</b>                        |
| 2:45 - 4 p.m. | <p><b><i>Becoming a Postdoc: How to Choose the Right Mentor and Make the Most of Your Postdoctoral Training (23)</i></b></p> <p><i>Presenter: J. Marcela Hernandez</i>, Administrative Director, The Ohio State University, Columbus, OH</p>  | <b>M101</b>                        |
| 2:45 - 4 p.m. | <p><b><i>Everything a New Faculty Member Needs to Know About Becoming an Effective Advisor and Mentor (24)</i></b></p> <p><i>Presiding and Presenter: Loretta Neal McGregor</i>, Professor of Psychology, Arkansas State University, Jonesboro, AR</p> <p><i>Presenter: Ana J. Bridges</i>, Professor, Department of Psychological Science, University of Arkansas, Fayetteville, AR</p>  | <b>M303</b>                        |
| 2:45 - 4 p.m. | <p><b><i>Prestigious Scholarship and Fellowship Opportunities (25)</i></b></p> <p><i>Presenter: Anissa Brown</i>, Program Director, Division of Training, Workforce Development, and Diversity (TWD), National Institute of General Medical Sciences, National Institutes of Health (NIGMS/NIH), Bethesda, MD</p> <p><i>Presenter: Carleen Velez</i>, Fulbright Outreach and Recruitment Specialist, Institute of International Education, Washington, DC</p> <p><i>Presenter: Tasha Inniss</i>, Associate Provost for Research, Office of Research, Innovation and Collaboration (ORIC), Spelman College, Atlanta, GA</p> <p><i>Presenter: Vandhana Lal</i>, NASA Fellowships Activity Manager, Minority University Research and Education Project (MUREP) and STEM Engagement Specialist, NASA Ames, Washington, DC</p> | <b>M304</b>                        |
| 2:45 - 4 p.m. | <p><b><i>Letters of Reference and Recommendation: How to Get and Write the Very Best (Open to all Institute attendees and required for NSF/STEM participants: Session 7) (26)</i></b></p> <p><i>Presenter: Michael Westrate</i>, Director, Center for Research and Fellowships, Villanova University, Villanova, PA</p>   | <b>M106 &amp; M107</b>             |
| 2:45 - 4 p.m. | <p><b><i>Notes from a Faculty Search Committee Chair (27)</i></b></p> <p><i>Presenter: Ali Gordon</i>, Interim Associate Dean of Graduate Affairs, and Associate Professor, University of Central Florida, Orlando, FL</p>  | <b>M104</b>                        |
| 4 - 5:15 p.m. | <p><b>Networking Break/Faculty Recruiting Station Visits</b></p> <p><i>(Faculty recruiting stations are open until Saturday. Scholars are encouraged to visit.)</i></p>   | <b>Marquis and Imperial Foyers</b> |

## Friday, October 25, *continued*

4 - 5:15 p.m.	<b>NSF/STEM Fellowships Boot Camp One-on-One Consultation Sessions (Required for NSF/STEM participants)</b>	<b>L507</b>
5:15 - 5:30 p.m.	<b>Recruiters Photos</b>	<b>Imperial Ballroom</b>
5:30 - 6:30 p.m.	<b>INSTITUTE GRADUATES' AWARDS PROGRAM</b>  Scholars who received their doctoral degrees in the 2018-2019 academic year will be recognized at the Awards Banquet.  <i>Presiding:</i> <b>Dewayne Matthews</b> , Lumina Foundation Fellow, Lumina Foundation, Indianapolis, IN	<b>Marquis Ballroom</b>
6:30 - 7:30 p.m.	<b>AWARDS DINNER</b>  <i>Presenter:</i> <b>Ansley Abraham</b> , Director, SREB-State Doctoral Scholars Program, Southern Regional Education Board, Atlanta, G	<b>Marquis Ballroom</b>

## Saturday, October 26

7:30 a.m. - 12:45 p.m.	<b>REGISTRATION AND CHECK-IN</b>	<b>Imperial Foyer</b>
7 - 8 a.m.	<b>Breakfast Meeting (Optional) for Recruiters, Administrators, Faculty and Guests: Partnering with the SREB-State Doctoral Scholars Program and the Compact Institute</b>  <i>Presiding:</i> <b>Robert L. Belle Jr.</b> , Senior Consultant, SREB-State Doctoral Scholars Program, Southern Regional Education Board, Atlanta, GA  <i>Presenter:</i> <b>Ansley Abraham</b> , Director, SREB-State Doctoral Scholars Program, Southern Regional Education Board, Atlanta, GA	<b>Marquis Salon D</b>
<b>CHALK TALKS AND NETWORKING BREAKFASTS BY DISCIPLINE</b>		
7 - 8 a.m.	<b>Health Sciences (28)</b>  <i>Presiding:</i> <b>Jennifaye Brown</b> , Assistant Clinical Professor, Division of Physical Therapy, Ohio University, Athens, OH	<b>M101</b>
7 - 8 a.m.	<b>Other Disciplines (29)</b>  <i>Presiding:</i> <b>Annie Liner</b> , Assistant Professor of Educational Psychology, Indiana State University, Terra Haute, IN	<b>M102</b>
7 - 8 a.m.	<b>Biological Sciences (30)</b>  <i>Presiding:</i> <b>Jessica Gadsden Gray</b> , SREB-State Doctoral Scholars Program Graduate, Meharry Medical College, Nashville, TN	<b>M106 &amp; M107</b>
7 - 8 a.m.	<b>Physical Sciences (31)</b>  <i>Presiding:</i> <b>B. Nalani Butler</b> , Assistant Professor of Sport Management, Kennesaw State University, Kennesaw, GA	<b>M302</b>
7 - 8 a.m.	<b>Engineering, Computer Sciences and Mathematics (32)</b>  <i>Presiding:</i> <b>Myrte de Alfred</b> , Research Assistant and Professor, Medical University of South Carolina, Charleston, SC	<b>M104</b>
7 - 8 a.m.	<b>Social Sciences (except Psychology) (33)</b>  <i>Presiding:</i> <b>Antionette Denise Stroter</b> , Adjunct Professor and Director of Research & Evaluation, Liberty University, Lynchburg, VA	<b>M105</b>
7 - 8 a.m.	<b>Psychology (34)</b>  <i>Presiding:</i> <b>Tiarney Ritchwood</b> , Assistant Professor, Family Medicine and Community Health, Duke University School of Medicine, Durham, NC	<b>M103</b>
7 - 8 a.m.	<b>Education and the Humanities (35)</b>  <i>Presiding:</i> <b>Julia Wilkins</b> , SREB-State Doctoral Scholars Program Graduate, University of Missouri-St. Louis, St. Louis, MO	<b>M304</b>

## Saturday, October 26, *continued*

8:15 - 9:30 a.m.	<b>NSF/STEM Fellowships Boot Camp Session 8: Other Application Materials; Essay Revisions (Open to all Institute attendees and required for NSF/STEM participants)</b>	<b>L508</b>
	<i>Presiding: Michael Westrate</i> , Director, Center for Research and Fellowships, Villanova University, Villanova, PA	
8:15 - 9:30 a.m.	<b>PLENARY SESSION II: <i>The Responsibility of Excellence</i></b>	<b>Marquis Ballroom</b>
	<i>Presiding: Ansley Abraham</i> , Director, SREB-State Doctoral Scholars Program, Southern Regional Education Board, Atlanta, GA	
	<i>Presenter: Kamau Bobb</i> , Global Lead for Diversity Strategy and Research, Google, and founding Senior Director of the Constellations Center for Equity in Computing, Georgia Tech, Atlanta, GA	
9 a.m. - 3 p.m.	<b>Recruiter Interviews (Optional)</b> <i>(Space available for recruiters to conduct interviews as needed)</i>	<b>A702</b>
9:30 - 10:15 a.m.	<b>Networking Break/Faculty Recruiting Station Visits</b> <i>(Faculty recruiting stations are open until Saturday. Scholars are encouraged to visit.)</i>	<b>Marquis and Imperial Foyers</b>
<b>CONCURRENT INTEREST SESSIONS</b>		
10:15 - 11:30 a.m.	<b><i>Undergraduate Session II: What Can I Do to Contribute to a Good Mentoring Relationship with my Faculty Mentor? (36)</i></b>	<b>M106 &amp; M107</b>
	<i>Presenter: Thomas Rochon</i> , President, Educational Records Bureau, Newton, CT	
10:15 - 11:30 a.m.	<b><i>Negotiating Your First Faculty Position (Recommended for advanced doctoral scholars) (37)</i></b>	<b>M105</b>
	<i>Presenter: Kofi Lomotey</i> , Bardo Distinguished Professor, Department of Human Services, College of Education/Allied Professions, Western Carolina University, Cullowhee, NC	
10:15 - 11:30 a.m.	<b><i>Women of Color in Academia (38)</i></b>	<b>M104</b>
	<i>Presenter: Sonja Montas-Hunter</i> , Assistant Vice Provost, Student Access & Success, Florida International University, Miami, FL	
	<i>Presenter: Sheila Gregory</i> , Professor, Educational Leadership and Higher Education, Clark Atlanta University, Atlanta, GA	
	<i>Presenter: Robin Starr Minthorn</i> , Director of Doctoral Program in Educational Leadership and Associate Professor, University of Washington, Tacoma, WA	

## Saturday, October 26, *continued*

- |                    |   |             |
|--------------------|---|-------------|
| 10:15 - 11:30 a.m. | <p><b><i>Teaching Inclusively: Professional Development in the CIRTl Network for Future STEM Faculty (39)</i></b></p> <p><i>Presenter: Don Gillian-Daniel</i>, Associate Director, University of Wisconsin-Madison, Madison, WI</p> <p><i>Presenter: Christopher Agard</i>, Adjunct Assistant Professor, Temple University, Roslyn, PA</p>  | M202        |
| 10:15 - 11:30 a.m. | <p><b>FACULTY SESSION II: <i>Setting Students Up for Fulfilling Career Pathways (Joint Session: SLOAN UCEM Leaders and Faculty) (40)</i></b></p> <p><i>Presenter: Hironao Okahana</i>, Associate Vice Present, Research &amp; Policy Analysis, Council of Graduate Schools, Washington, DC</p>  | L401 & L402 |
| 10:15 - 11:30 a.m. | <p><b><i>How Can One Maintain Flexible Pathways Across Academia, Industry, and Practice? (41)</i></b></p> <p><i>Presenter: Tatia Granger</i>, Clinical Associate Professor, Organizational Behavior, College of William and Mary, Williamsburg, VA</p>  | M109        |
| 10:15 - 11:30 a.m. | <p><b><i>The Institute on Teaching and Mentoring Evaluation Study (42)</i></b></p> <p><i>Gaining Ground: Empirical Evidence of the Impacts of the Institute on Teaching and Mentoring</i></p> <p><i>Presenter: David Feldon</i>, Professor of Instructional Technology and Learning Sciences, and Director of Graduate Program Assessment, Utah State University, Logan, UT</p>   | M103        |
| 10:15 - 11:30 a.m. | <p><b><i>Getting PhinisheD/FinishEdD #WhoGotNext (43)</i></b></p> <p><i>Presenter: Daniel Jean</i>, Executive Director of the Educational Opportunity Fund Program and Founder of Wordstravel.org, Montclair State University, Haledon, NJ</p>  | M302        |
| 10:15 - 11:30 a.m. | <p><b><i>Curriculum Vitae (CV) Reviews III</i></b></p> <p>The Institute will offer CV review sessions again this year. If you signed up for a review and brought your CV or resume, you will receive a review by a recruiter. The review will give you immediate feedback on how to strengthen your CV or resume to stand out from others. Arrive early for your appointed time; you do not want to miss this unique opportunity to further your career in the academy.</p> | A704        |
| 10:15 - 11:30 a.m. | <p><b><i>Building Riches with Research: 10 Steps to Starting a Profitable Business (44)</i></b></p> <p><i>Presenter: Karen Hinds</i>, President and Chief Executive Officer, Workplace Success Group, Waterbury, CT</p>   | L403        |

## Saturday, October 26, *continued*

### CONCURRENT INTEREST SESSIONS

10:15 - 11:30 a.m.	<b><i>Teaching Session II: Student-Centered Teaching — Designing Your Course Methods, Assignments and Assessments to Optimize the Student’s Opportunity to Learn (45)</i></b>	<b>M101</b>
	<i>Presenter: Edwin J. Barea-Rodriguez</i> , Professor and Associate Dean for Student Success and Instructional Innovation, University of Texas at San Antonio, San Antonio, TX	
11:45 a.m. - 1 p.m.	<b><i>NSF/STEM Fellowships Boot Camp Session 9: Adapting Your Application to Other Opportunities (Open to all Institute attendees and required for NSF/STEM participants)</i></b>	<b>L508</b>
	<i>Presiding: Michael Westrate</i> , Director, Center for Research and Fellowships, Villanova University, Villanova, PA	
11:45 a.m. - 1 p.m.	<b><i>Sloan Scholars Mentoring Network (46)</i></b>	<b>M106 &amp; M107</b>
	<i>Presenter: Alma Granado</i> , Program Director, Sloan Scholars Mentoring Network, Social Science Research Council, Brooklyn, NY	
11:45 a.m. - 1 p.m.	<b><i>Implicit Bias: How It Shows Up in the Academy and How to Survive and Thrive in Spite of It (47)</i></b>	<b>M105</b>
	<i>Presenter: Kumea Shorter-Gooden</i> , Principal, Shorter-Gooden Consulting, Washington, DC	
11:45 a.m. - 1 p.m.	<b><i>What Does It Take to Become a Radical Public Intellectual? (48)</i></b>	<b>M101</b>
	<i>Presenter: Karsonya Wise Whitehead</i> , Associate Professor, Department of Communications, Loyola University Maryland, Baltimore, MD	
11:45 a.m. - 1 p.m.	<b><i>Taking Care of YOU: Self-Care as a Strategy for Success (49)</i></b>	<b>L401 &amp; L402</b>
	<i>Presenter: Lynn Curry</i> , McNair Director, Central Michigan University, Mount Pleasant, MI	
11:45 a.m. - 1 p.m.	<b><i>Fostering Affirming Learning Environments for LGBTQI+ Students (50)</i></b>	<b>M104</b>
	<i>Presenter: David Rivera</i> , Associate Professor, Queens College of the City University of New York, Queens, NY	
11:45 a.m. - 1 p.m.	<b><i>What Is the Worldview of the Entering Class of College Freshmen — Students You Will Be Teaching? (51)</i></b>	<b>M202</b>
	<i>Presenter: Tom McBride</i> , Professor Emeritus, Beloit College, Madison, WI	
	<i>Presenter: Charles Westerberg</i> , Professor and Brannon-Ballard Chair in Sociology, Beloit College, Beloit, WI	



## Saturday, October 26, *continued*

11:45 a.m. - 1 p.m.	<p><b><i>Presenting Research Effectively (52)</i></b></p> <p><i>Presenter: Colleen McLinn</i>, Executive Director, CIRTLL (Center for the Integration of Research, Teaching, and Learning), Cornell University, Ithaca, NY</p> <p><i>Presenter: Tammy M. McCoy</i>, TA Development and Future Faculty Specialist, Center for Teaching and Learning, Georgia Institute of Technology, Atlanta, GA</p>	M109
11:45 a.m. - 1 p.m.	<p><b><i>FACULTY SESSION III: The Gateway Grant Model: How to Support Applicants for Prestigious National Fellowships (53)</i></b></p> <p><i>Presenter: Michael Westrate</i>, Director, Center for Research and Fellowships, Villanova University, Villanova, PA</p>	M302
11:45 a.m. - 1 p.m.	<p><b><i>Finding the Sweet Spot: Developing a Positive Relationship with Your Advisor and Mentors (54)</i></b></p> <p><i>Presenter: Ruth Washington</i>, Executive Director for Faculty and Graduate Student Retention, Inclusion and Success, Kent State University, Kent, OH</p> <p><i>Presenter: Ailton Santonio Coleman</i>, MPH, Assistant Professor, James Madison University, Harrisonburg, VA</p>	M103
11:45 a.m. - 1 p.m.	<p><b><i>A Conversation With the Elders (55)</i></b></p> <p><i>Presenter: Ken Pepion</i>, Higher Education Consultant, Durango, CO</p> <p><i>Presenter: Harold Bibb</i>, Associate Dean (retired), Graduate School, University of Rhode Island, Kingston, RI</p> <p><i>Presenter: Orlando L. Taylor</i>, Vice President for Strategic Initiatives and Research, and Director of the Center for Social Innovation, Fielding Graduate University, Washington, DC</p> <p><i>Presenter: Belinda Anderson</i>, President (Retired), Virginia Union University, Richmond, VA</p> <p><i>Presenter: Edwin J. Barea-Rodriguez</i>, Professor and Associate Dean for Student Success and Instructional Innovation, University of Texas at San Antonio, San Antonio, TX</p>	L403
1 - 2:30 p.m.	<p><b>LUNCHEON AND AWARDS PROGRAM</b></p> <p><i>Presiding: Dewayne Matthews</i>, Lumina Foundation Fellow, Lumina Foundation, Indianapolis, IN</p>	Marquis Ballroom
2:30 - 3 p.m.	<p><b>Networking Break/Faculty Recruiting Station Visits</b></p> <p><i>(Faculty recruiting stations are open until 3 p.m. Saturday. Scholars are encouraged to visit.)</i></p>	Marquis and Imperial Foyers

## Saturday, October 26, *continued*

2:30 - 4 p.m.	<b>REGISTRATION AND CHECK-IN</b>	<b>Imperial Foyer</b>
3 - 5 p.m.	<b>NSF/STEM Fellowships Boot Camp Session 10: Adapting Your Application, Program Evaluation (Open to all Institute attendees and required for NSF/STEM participants)</b>  <i>Presenter: Michael Westrate</i> , Director, Center for Research and Fellowships, Villanova University, Villanova, PA	<b>L508</b>
3 - 4 p.m.	<b>Group Photos</b>  Each year, the Institute organizes one group photo of all participants. This is followed by individual group photo sessions.  Group photos will be taken in the following order: SREB SLOAN SSRC AGEP/Guest Scholars Gates NASA McNair/SSS LSAMP New England	<b>Imperial Ballroom</b>
4 - 11 p.m.	<b>Free time. Dinner is on your own.</b>	

## Sunday, October 27

8 - 9:30 a.m.	<b>NSF/STEM Fellowships Boot Camp One-on-One Consultation Sessions (Required for NSF/STEM participants)</b>	<b>L507</b>
8:15 - 9:30 a.m.	<b>NASA Scholars Meeting with NASA Representatives (56)</b> <i>Presiding:</i> <b>Torry Johson</b> , Manager, Minority University Research and Education Project (MUREP), NASA, Washington, DC <i>Presenter:</i> <b>Erica J. Alston</b> , Deputy Manager, National Space Grant College and Fellowship Program (Space Grant), NASA Langley Research Center, Office of STEM Engagement, Washington, DC <i>Presenter:</i> <b>Taifa Simpson</b> , Program Manager, NASA Postdoctoral Program (NPP), Universities Space Research Association (USRA), Washington, CT	<b>M101</b>
8:15 - 9:30 a.m.	<b>Undergraduate Session III: Grants and Fellowships 101: Who, What, When, How (57)</b> <i>Presenter:</i> <b>Michael Westrate</b> , Director, Center for Research and Fellowships, Villanova University, Villanova, PA	<b>M104</b>
8:30 - 9:30 a.m.	<b>First-Year SREB-State Doctoral Scholars Meeting (Required)</b> <i>Presenter:</i> <b>Ansley Abraham</b> , Director, SREB-State Doctoral Scholars Program, Southern Regional Education Board, Atlanta, GA <i>Presenter:</i> <b>Monique Waddell</b> , Scholar Services Coordinator, SREB-State Doctoral Scholars Program, Southern Regional Education Board, Atlanta, GA	<b>Marquis Salon D</b>
8:30 - 9:45 a.m.	<b>Closing Session for Sloan Scholars, UCEM Leaders and MPhD</b> <i>Presiding:</i> <b>Elizabeth S. Boylan</b> , Program Director, Alfred P. Sloan Foundation, New York, NY <i>Presenter:</i> <b>Sweeney Windchief</b> , Assistant Professor, Department of Education, Montana State University, Bozeman, MT	<b>M103, M104 &amp; M105</b>
9:45 - 11:30 a.m.	<b>Brunch and Closing Session</b> <i>Presiding:</i> <b>Ken Pepion</b> , Higher Education Consultant, Durango, CO <i>Presenter:</i> <b>Julio C. Hernandez</b> , Chief of Staff, Division of Inclusion and Equity, Clemson University, Clemson, SC	<b>Marquis Ballroom</b>
11:30 a.m. - Noon	<b>Adjournment</b>	

# Alfred P. Sloan Minority Ph.D. Program Agenda

## 2019 Conference at the Institute for Teaching and Mentoring

### Thursday, October 24

Noon - 5 p.m.	<b>Registration and Check-In</b>	<b>Imperial Foyer</b>
5:30 - 6:30 p.m.	<b>Orientation for Sloan Scholars, Sloan Graduates, UCEM Leaders and MPHD Faculty (ALL SLOAN)</b>  <b>Topic: <i>Establishing Your Professional Identity Part I, and How to Maximize Your Time at the Institute</i></b>  <i>Presiding:</i> <b>Elizabeth S. Boylan</b> , Program Director, Alfred P. Sloan Foundation, New York, NY  <i>Presenter:</i> <b>Sara Xayarath Hernandez</b> , Associate Dean for Inclusion and Student Engagement, Graduate School, Cornell University, Ithaca, NY  <i>Presenter:</i> <b>Calvin Howell</b> , Professor of Physics, Duke University, Durham, NC  <i>Presenter:</i> <b>Jorge Calabria</b> , Research Assistant, University of South Florida, Tampa, FL  <i>Presenter:</i> <b>Indira Turney</b> , Postdoctoral Research Scientist, Columbia University Irving Medical Center, New York, NY	<b>M302 &amp; M303</b>
6:45 – 8:15 p.m.	<b>Welcome Reception and Networking Event (ALL SLOAN)</b>  <b>Topic: <i>Sloan Strategic Messaging</i></b>  <i>Presiding:</i> <b>Elizabeth S. Boylan</b> , Program Director, Alfred P. Sloan Foundation, New York, NY  <i>Welcome Remarks:</i> <b>Adam Falk</b> , President, Alfred P. Sloan Foundation, New York, NY  <i>Presenter:</i> <b>Nate Williams</b> , Communications Manager, Alfred P. Sloan Foundation, New York, NY	<b>Marquis Salon D</b>

### Friday, October 25

7 - 8:30 a.m.	<b>Breakfast Meeting (ALL SLOAN)</b>  <b>Topic: <i>Establishing Your Professional Identity Part II</i></b>  <i>Presiding:</i> <b>Alma Granado</b> , Program Director of the Sloan Scholars Mentoring Network, Social Science Research Council, Brooklyn, NY  <i>Presenter:</i> <b>Deji Akinwande</b> , David & Doris Lybarger Endowed Faculty Fellowship in Engineering, and Professor, University of Texas at Austin, TX  <i>Table Discussion Leaders:</i> <b>Sloan graduates and facilitators in SSMN</b>  <i>Closing Remarks:</i> <b>Deji Akinwande</b> and <b>Sara Xayarath Hernandez</b>  <b>Breakfast starts at 7 a.m.</b> <b>Session starts at 7:20 a.m. PLEASE BE PROMPT.</b>	<b>Marquis Salon D</b>
---------------	--	------------------------

## Friday, October 25, *continued*

8:45 – 10:15 a.m.	<b>Welcome, Opening Session and Keynote Addresses</b> ( <i>ALL SLOAN</i> ) <i>Presiding: Ansley Abraham</i> , Director, SREB-State Doctoral Scholars Program, Southern Regional Education Board, Atlanta, GA <i>Presenter: Shirley Malcom</i> , Senior Advisor, American Association for the Advancement of Science, Center for Scientific Evidence in Public Issues, Washington, D.C. <i>Presenter: Antentor Othrell Hinton Jr.</i> , Ford Foundation and Burroughs Wellcome Fund Postdoctoral Fellow, University of Iowa, Iowa City, IA <i>Presenter: Thelma Y. Garcia</i> , Lab Research and Administrative Manager, Newman Lab, The Buck Institute, Novato, CA	Marquis Salon A-C
11 a.m - 12:15 p.m.	<b>Sloan UCEM Leaders Meeting I</b> <b>Topic: <i>Diversity and the Law Project: What It Means for Your Campus</i></b> <i>Presenter: Shirley Malcom</i> , Senior Advisor, American Association for the Advancement of Science, Center for Scientific Evidence in Public Issues, Washington, D.C.	M301
11 a.m - 12:15 p.m.	<b>Choice from Parallel Offerings</b> ( <i>SLOAN Scholars</i> ) See Agenda in Detail	
12:30 - 2 p.m.	<b>Meet and Greet Luncheon and Plenary Session I</b> ( <i>ALL SLOAN</i> ) <i>Presiding: Ansley Abraham</i> , Director, SREB-State Doctoral Scholars Program, Southern Regional Education Board, Atlanta, GA <i>Presenter: Stephen L. Pruitt</i> , President, Southern Regional Education Board, Atlanta, GA <i>Presenter: Robert L. Belle Jr.</i> , Senior Consultant, SREB-State Doctoral Scholars Program, Southern Regional Education Board, Atlanta, GA	Marquis Salon A-C
2 - 4:30 p.m.	<b>Registration and Check-In</b>	Imperial Foyer
2:30 - 4:30 p.m.	<b>Sloan UCEM Leaders Meeting II</b> <b>Topic: <i>Progress Report on Sloan Indigenous Graduate Partnership (2:30 - 4 p.m.)</i></b> <i>Presenter: Kevin Gibson</i> , Professor, Botany and Plant Pathology, Purdue University, and Co-PI for SIGP at Purdue University <i>Presenter: Sweeney Windchief</i> , Assistant Professor, Department of Education, Montana State University, and Co-PI for SIGP at Montana State University <b>Topic: <i>Sloan Foundation Staffing (4 - 4:30 p.m.)</i></b> <i>Presiding: Elizabeth S. Boylan</i> , Program Director, Alfred P. Sloan Foundation, New York, NY	M301
2:30 - 4:30 p.m.	<b>Choice from Parallel Offerings</b> ( <i>SLOAN Scholars</i> ) See Agenda in Detail	



## Saturday, October 26

5:30 - 7:30 p.m.	<b>Institute Graduates' Award Banquet</b> ( <i>ALL SLOAN</i> ) <i>Presiding: Dewayne Matthews</i> , Lumina Foundation Fellow, Lumina Foundation, Quebec, CAN	<b>Marquis Salons A-C</b>
7 - 8 a.m.	<b>Chalk Talks and Networking Breakfasts by Discipline</b> ( <i>SLOAN Scholars</i> ) See Agenda in Detail	
8:15 - 9:45 a.m.	<b>Sloan UCEM Leaders Meeting III</b> Facilitated discussion among UCEM Leaders — see separate invitation and information.	<b>M301</b>
10:15 - 11:30 a.m.	<b>Joint Session: Sloan UCEM Leaders Meeting IV and SREB Faculty</b> <b>Topic: <i>Setting Students Up for Fulfilling Career Pathways</i></b> <i>Presenter: Hironao Okahana</i> , Associate Vice President, Research and Policy Analysis, Council of Graduate Schools (CGS), Washington, DC <i>The Alfred P. Sloan Foundation was pleased to be one of the initial sponsors of this CGS project.</i>	<b>L401-L402</b>
11:45 a.m. - 1 p.m.	<b>Sloan UCEM Leaders Meeting V</b> Facilitated discussion among UCEM Leaders — see separate invitation and information.	<b>M301</b>
11:45 a.m. - 1 p.m.	<b>ALTERNATIVE: SREB Faculty Session III:</b> The Gateway Grant Model: How to Support Applicants for Prestigious National Fellowships <i>Presenter: Michael Westrate</i> , Director, Center for Research and Fellowships, Villanova University, Villanova, PA	<b>M302</b>
11:45 a.m. - 1 p.m.	<b>Sloan Scholars Mentoring Network</b> ( <i>SLOAN Scholars</i> ) See Agenda in Detail <i>Presenter: Alma Granado</i> , Program Director of the Sloan Scholars Mentoring Network, Social Science Research Council, Brooklyn, NY	<b>M106-107</b>
1 - 2:30 p.m.	<b>Luncheon and Awards Program</b> ( <i>ALL SLOAN</i> )	<b>Marquis Salons A-C</b>
3 - 4 p.m.	<b>Group Photos</b> ( <i>ALL SLOAN</i> )	<b>Imperial Ballroom</b>

## Sunday, October 27, *continued*

- 8:30 - 9:45 a.m.    **Closing Session for Sloan Scholars, UCEM Leaders and MPHD**    **M103, M104, & M105**  
(*ALL SLOAN*)  
*Light breakfast served*
- Presiding:* **Elizabeth S. Boylan**, Program Director, Alfred P. Sloan Foundation, New York, NY
- Presenter:* **Sweeney Windchief**, Assistant Professor, Department of Education, Montana State University, and Co-PI for SIGP at Montana State University, Bozeman, MT
- 9:45 - 11:30 a.m.    **SREB Institute Brunch and Closing Session** (*ALL SLOAN*)    **Marquis Salons A-C**
- Presiding:* **Ansley Abraham**, Director, SREB-State Doctoral Scholars Program, Southern Regional Education Board, Atlanta, GA
- Presenter:* **Julio C. Hernandez**, Chief of Staff, Division of Inclusion and Equity, Clemson University, Clemson, SC

# MSU Denver is where learners connect with leaders.

99% of our classes are taught by  
faculty, not teaching assistants. They  
are industry icons, national experts  
and have the highest degrees in their  
disciplines.

That's **possible** here.



METROPOLITAN  
STATE UNIVERSITY<sup>SM</sup>  
OF DENVER

[msudenverjobs.com](http://msudenverjobs.com)

# Become a 2020 Sponsor

To become a sponsor, please visit

<https://www.sreb.org/dsp-donate>

Enter the keyword "FRIENDS" in the special instructions field.

## Levels of Sponsorship:

SILVER Sponsor	\$4,000
BRONZE Sponsor	\$3,000
COPPER Sponsor	\$2,000

Please direct questions regarding sponsorship to  
Veronica Johnson, Communications Specialist, SREB-State Doctoral Scholars Program  
[veronica.johnson@sreb.org](mailto:veronica.johnson@sreb.org) or 404-879-5536.

The Southern Regional Education Board is a 501(c)(3) not for profit organization.  
Federal ID No. 58-0566141