



GAYLORD
PALMS®

RESORT & CONVENTION CENTER



Welcome to Gaylord Palms!

Gaylord Hotels are renowned for their magnificent atriums and “everything in one place” approach to meetings. Each of our spectacular resorts is located in an exceptionally convenient and desirable destination, and is purpose-built to meet the needs of both meeting planners and attendees. The breathtaking Gaylord Palms Resort & Convention Center in Kissimmee, Florida, offers a unique meetings experience in a remarkable setting, celebrating the diverse beauty and history of the Sunshine State while guaranteeing a memorable event that goes far beyond the boundaries of typical convention hotels — and exceeds the expectations of your attendees.

Extraordinary environments, meetings expertise, and service with a passion – all under one awe-inspiring roof.

Dedication to these principles is what sets Gaylord Hotels apart, and it’s the secret to your next successful meeting.

TABLE OF CONTENTS

2	Hotel Overview
6	Overview Map
7	Level Map
	CONVENTION CENTER
8-11	Sun, Osceola & Coastal Ballrooms
12-15	Sun, Osceola & Coastal Breakout Rooms
16	Florida Exhibition Hall
	HOTEL-SIDE
17	Palm Beach Meeting Room & Orange Blossom Ballroom
18	St. George Meeting Rooms
19	Emerald Bay Meeting Rooms
20	Executive Center
	FLEX-SPACE
21	Atrium Space
22	Coquina Lawn
23	Mangrove Lawn
24	MOOR
25	Old Hickory Steakhouse
26	Wreckers Sports Bar
27	Villa de Flora & Socio
28	Convertible Guest Rooms/Hospitality Suites



Let the Sun Shine In!

Bask in the hot spot for Florida meetings — the spectacular Gaylord Palms!

Conveniently located in Kissimmee, Florida, Gaylord Palms Resort features four-and-a-half acres of beautiful indoor gardens celebrating the history, culture, and natural beauty of Florida. The lush Everglades-themed atrium is rustic and cool—a perfect setting for our signature Old Hickory Steakhouse. The St. Augustine atrium includes a replica of a 17th-century Spanish fort that can be reserved for unique events, while the island-inspired Key West atrium is home to MOOR, a sea-to-table restaurant featuring locally-sourced dishes with a focus on fresh seafood.

With over 500,000 square feet of flexible meeting space as well as a variety of unique networking venues, Gaylord Palms has everything you need, all in one place. For large groups, the convention center offers ballrooms, breakout rooms, and the Florida Exhibition Hall. For small and executive-sized meetings, state-of-the-art boardrooms and other hotel-side space provide the ideal atmosphere.

For special, one-of-a-kind functions, impress your attendees with unique settings such as the outdoor Coquina Lawn and the chic South Beach Pool, or combine dinner and discussion with a private meal in one of our regionally-themed restaurants. Our distinctive indoor and outdoor environments will transform your typical meeting into a spectacular event!

“Everything you need, all in one place.”

Take advantage of both formal and informal occasions to connect in our world-class restaurants, and enhance your meeting experience with a soothing treatment at Relâche Spa; retail therapy in our charming shops; or a swim in the adults-only South Beach Pool. The kid-friendly Cypress Springs Water Park is perfect for a rollover with the family, and all of Orlando’s world famous theme parks are just minutes away.

Quick Facts

- 1,718 guest rooms, including 129 suites
- Over 500,000 sq. ft. of flexible meeting, convention, outdoor, exhibit and pre-function space
 - 178,500 sq. ft. of dedicated exhibit space—the largest in-hotel exhibition hall in Florida
 - Five exquisite ballrooms:
 - Osceola (48,505 sq. ft.);
 - Coastal (30,417 sq. ft.);
 - Sun (29,124 sq. ft.);
 - Citrus (3,654 sq. ft.)
 - and Orange Blossom (3,115 sq. ft.)
 - 42-by-96-foot Broadway-style stage in Osceola Ballroom, equipped with built-in sound and lighting
 - Meeting Planner Offices adjacent to the Osceola & Sun Ballrooms
 - 104 conference and breakout rooms
 - Two boardrooms designed for executive meetings
 - Coquina Lawn – 16,176 sq. ft. of outdoor event space with three fire pit alcoves
 - Mangrove Lawn – 19,773 sq. ft. of flexible outdoor event space
- Emerald Bay, an exclusive environment for executive meetings with guest rooms and meeting rooms in close proximity
- In-house IT services allow for flexible and customizable packages
- Creative spaces for networking and socializing including unique outdoor venues
- Fiber optic network available to create a secure private Intranet among meeting rooms, exhibit hall, guest rooms and ballrooms
- Award-winning dining options including Old Hickory Steakhouse; MOOR; Villa de Flora; Socio and Wreckers Sports Bar
- Relax at the award-winning Relâche Spa, designed to accommodate large groups
- Recreation: South Beach Adult-Only Pool, Cypress Springs Water Park featuring a drop slide, racing slides, a double FlowRider, rapid river and a multi-level treehouse playground along with a zero-entry lagoon-style family pool, and nearby golf
- Set on 65 acres in Kissimmee, Florida—just minutes from Walt Disney World® Theme Parks and 20 minutes from Orlando International Airport





Meet the Extraordinary at Gaylord Palms Delivered with Flawless Precision

When it comes to planning meetings, think of Gaylord Palms as a canvas for your creativity — and our STARS as your artistic collaborators. From an executive summit in the elegantly appointed Hemingway Boardroom to a nighttime gathering beneath the stars, the seasoned staff at Gaylord Palms can bring your vision to life.

***“It’s the STARS who make meetings
at our resort so exceptional.”***

Event Experience Managers are Gaylord Hotels’ secret tool in the flawless execution of your vision. Through a comprehensive understanding of individual customer needs and complete expertise of the workings of the resort, our managers are ready to meet customers’ moment-to-moment needs.

As an extension to the onsite program team, they are property experts ensuring meeting rooms are set perfectly, speakers have what they need and the customer has access to all available resources. The result is always a level of service that raises the standard in the convention industry.

Ask our clients, and they’ll tell you that it’s the STARS who make meetings at our resort so exceptional. From catering to onsite marketing to technology support, our enthusiastic team is equally as invested in the success of your business as you are, and we demonstrate that commitment every step of the way.

Photographs: (Left Page, St. Augustine Atrium) (Right Page, meeting space)



Overview Map



COLOR LEGEND

- St. Augustine
- Key West
- Emerald Bay
- Everglades
- Convention Center
- Property Grounds

KEY

- Concierge
- Front Desk
- Valet
- Bus
- Taxi
- Car Rental
- Bell Services
- Smoking Area
- Restrooms
- Elevator
- Stairs
- Escalator
- FedEx Office Business Center
- ATM
- Guest Laundry (Lower Level)

DINING & DRINKS

- MOOR
- Villa de Flora (*Mediterranean Buffet*)
- Wreckers Sports Bar
- SandBar
- Old Hickory Steakhouse
- Socio

EATERY

- The Cocoa Bean Express
- The Cocoa Bean Coffee House
- Honeybells Frozen Yogurt
- Emerald Bay Marketplace
- The Cocoa Bean Express

SHOPPING

- Mallory Square Market
- Island Paradise
- Emerald Bay Emporium
- PGA TOUR Shop
- Brighton Collectibles
- Alligator Alley
- Relâche Spa Boutique

AMENITIES

- Arcade
- Relâche Spa (Lower Level)
- Relâche Fitness Center (Lower Level)
- South Beach Pool (Adults Only)
- Cypress Springs Water Park

MEETING SPACE

- 102 St. George Meeting Room
- 104 St. George Meeting Room
- 106 St. George Meeting Room
- 108 St. George Meeting Room
- Emerald Meeting Rooms (Lower Level)
- St. George Meeting Rooms, 112 - 114
- Orange Blossom Ballroom
- Boardrooms (Level 4)
- Palm Beach Meeting Room
- Convertible Guest Rooms/Hospitality Suites
- Coquina Lawn
- Mangrove Point

Please note that our hotel, atriums and pool areas are smoke-free. Smoking is permitted in various outdoor locations.

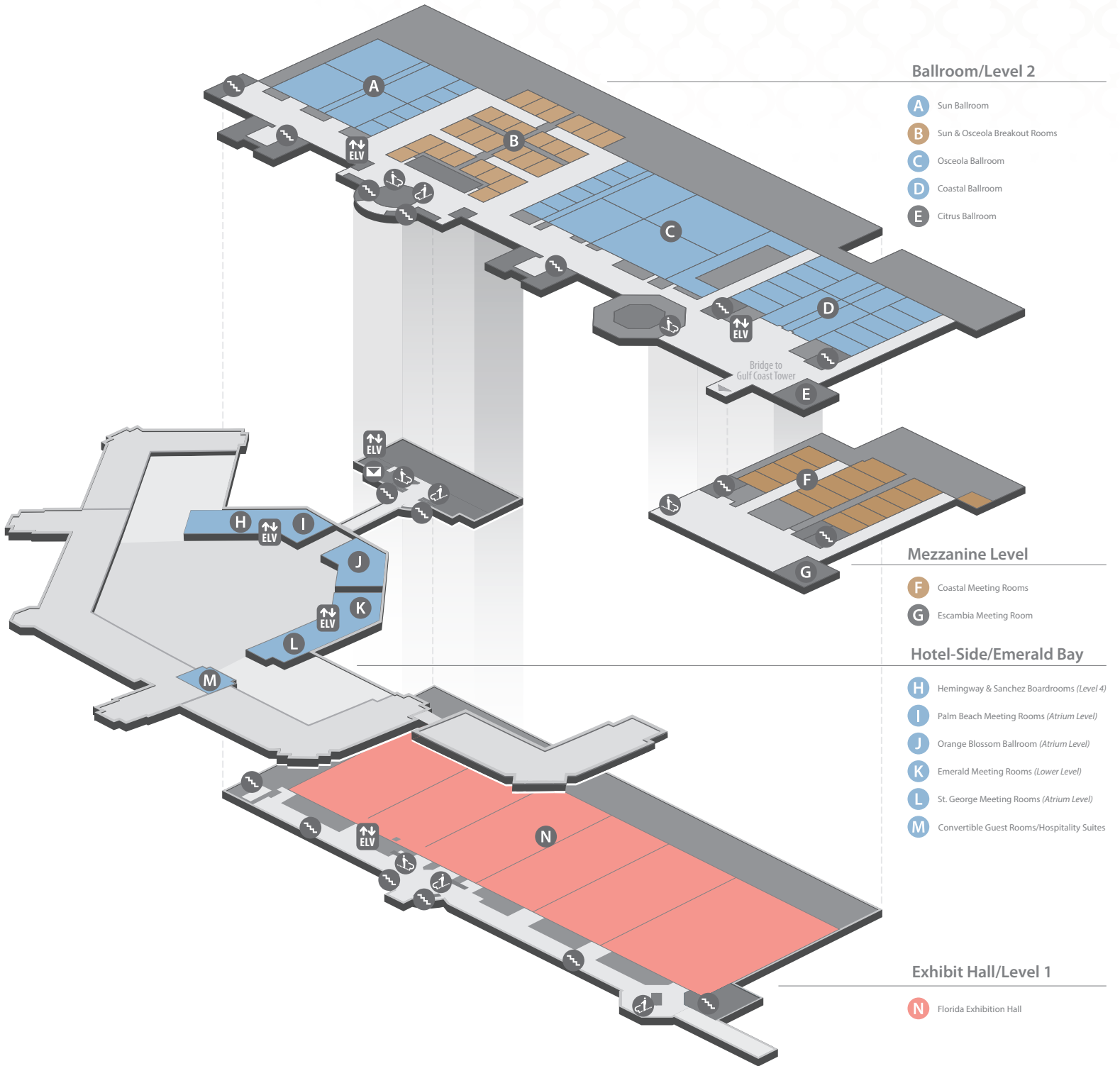

Sun, Osceola & Coastal Ballrooms

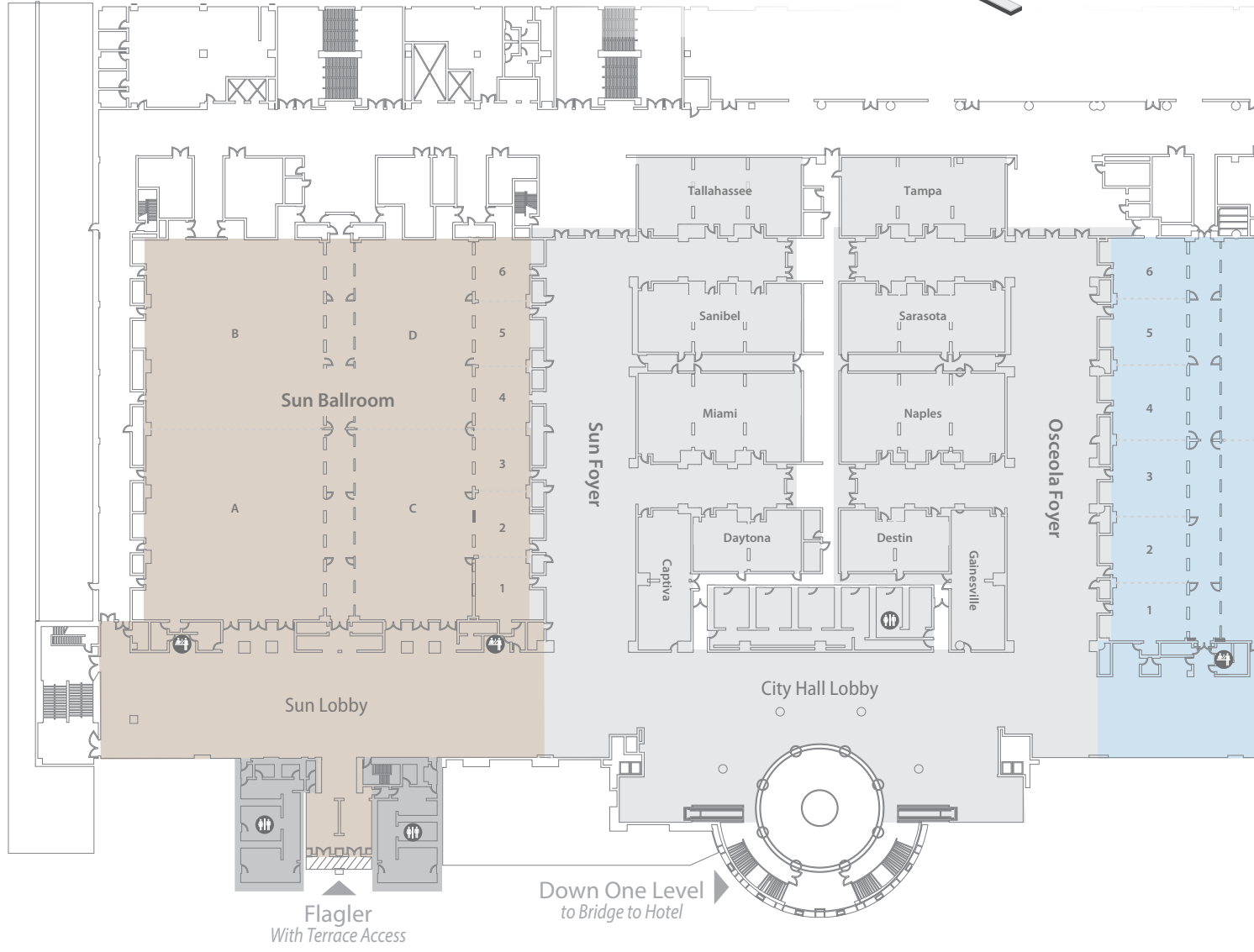
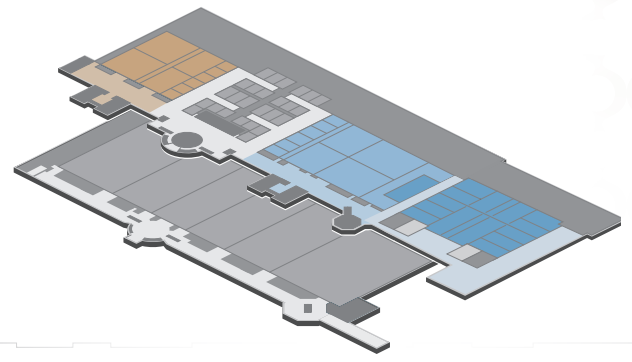

BALLROOM	L X W X H (FEET)	SQ.FT.	THEATER	CLASSROOM	CONFERENCE	U-SHAPE	ROUNDS (10)	RECEPTION
SUN BALLROOM	187x179x24	29,124	3,040	1,860			1,960	2,520
A	89x84x24	6,682	665	450			490	580
B	98x84x24	6,863	665	450			490	595
C	89x52x24	4,350	418	285			280	375
D	98x52x24	4,556	418	285			280	395
Breakouts								
1	33x30x24	767	70	34	34	28	40	65
2	30x29x24	762	72	45	34	26	40	65
3	27x27x24	663	71	45	34	26	40	55
4	27x27x24	667	71	45	34	26	40	60
5	30x29x24	768	73	45	34	26	40	65
6	42x30x24	809	69	34	34	28	40	70
Sun Lobby		9,992						
Flagler Room	28x21x12	592	50	28	22	22	30	

Capacities shown in this book are maximum for each room, with no staging or audio-visual, and should be used for reference only. Room capacities will be diminished based on your staging and audio-visual needs.

KEY

- Restrooms
- Family Restrooms
- Stairs
- Escalator
- Registration Desks
- Elevator
- Service Areas



COASTAL BALLROOM CAPACITY CHART PAGE 10

BALLROOM	LXWXH (FEET)	SQ.FT.	THEATER	CLASSROOM	CONFERENCE	U-SHAPE	ROUNDS (10)	RECEPTION
OSCEOLA BALLROOM	265x190x24	48,505	5,561	3,366			3,450	4,200
A	94x59x24	5,208	560	322			400	450
B	96x59x24	5,326	560	322			400	460
C	115x94x24	10,270	1,092	660			700	890
D	115x94x24	10,385	1,092	660			700	900
Breakouts								
1	39x32x24	949	89	49	40	29	60	80
2	39x29x24	1,005	105	63	40	29	70	90
3	39x33x24	1,171	112	74	46	32	90	100
4	39x32x24	1,132	112	74	46	32	90	100
5	39x29x24	1,008	105	69	40	30	80	85
6	39x35x24	988	93	50	40	30	60	85
Osceola Lobby		14,212						
Vero Room	28x21x12	592	50	28	22	22	30	

Capacities shown in this book are maximum for each room, with no staging or audio-visual, and should be used for reference only. Room capacities will be diminished based on your staging and audio-visual needs.

Coastal Ballroom

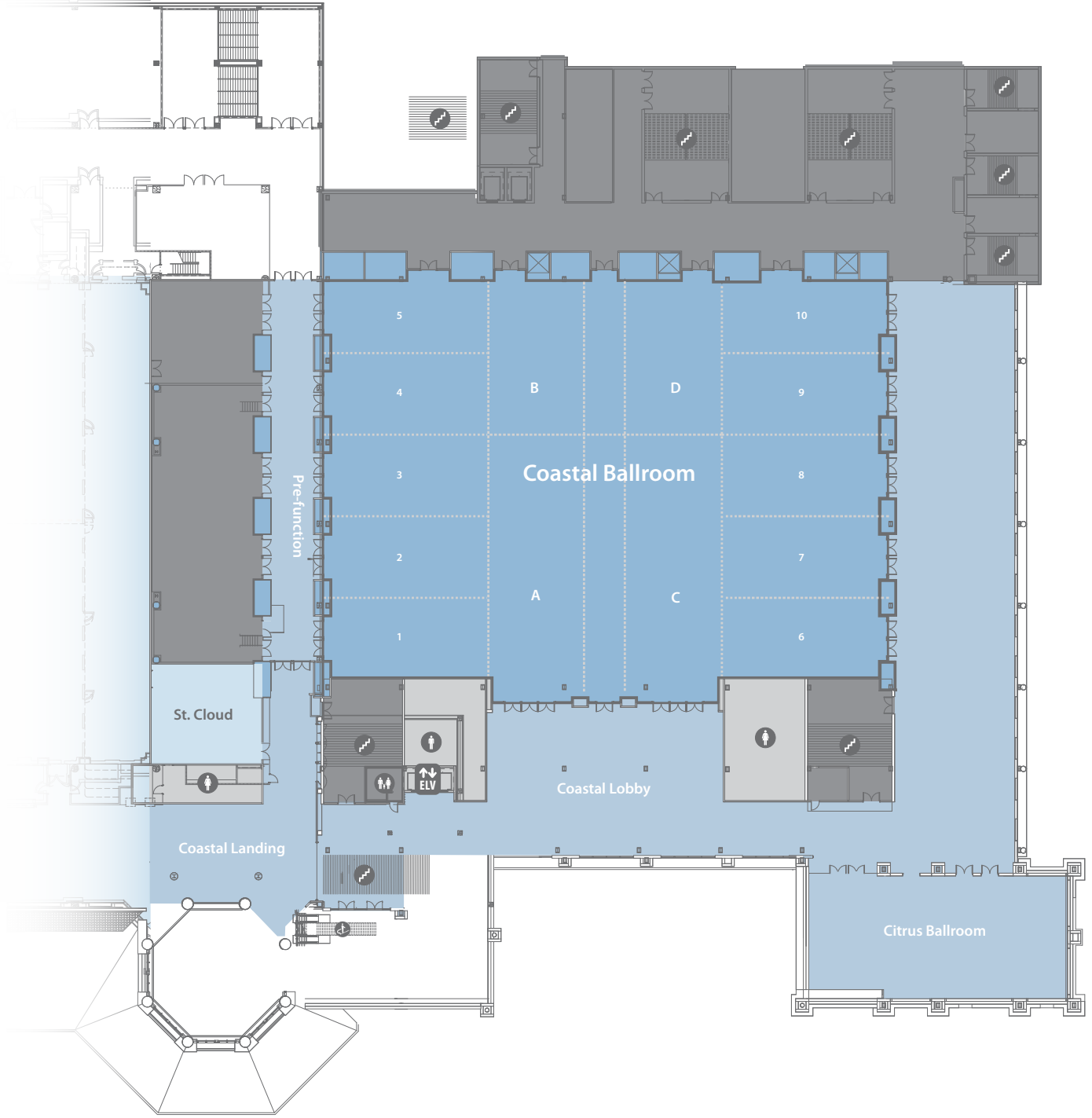
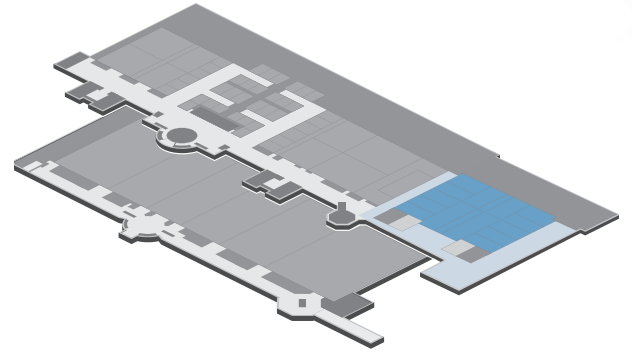

BALLROOM	L X W X H (FEET)	SQ.FT.	THEATER	CLASSROOM	CONFERENCE	U-SHAPE	ROUNDS (10)	RECEPTION
COASTAL BALLROOM	146x210x24	30,417	2,856	2,050			2,040	2,643
Coastal A	87x35x24	3,045	320	180			240	264
Coastal B	58x35x24	2,030	224	108	36	34	150	176
Coastal C	87x35x24	3,045	320	180			240	264
Coastal D	58x35x24	2,030	224	108	36	34	150	176
Breakouts								
Coastal 1	57x29x24	1,653	182	100	36	32	110	143
Coastal 2	57x29x24	1,653	182	100	36	32	110	143
Coastal 3	57x29x24	1,653	182	100	36	32	110	143
Coastal 4	57x29x24	1,653	182	100	36	32	110	143
Coastal 5	57x29x24	1,653	182	100	36	32	110	143
Coastal 6	57x29x24	1,653	182	100	36	32	110	143
Coastal 7	57x29x24	1,653	182	100	36	32	110	143
Coastal 8	57x29x24	1,653	182	100	36	32	110	143
Coastal 9	57x29x24	1,653	182	100	36	32	110	143
Coastal 10	57x29x24	1,653	182	100	36	32	110	143
CITRUS BALLROOM	87x42x24	3,654	410	210	56	56	210	314
Coastal Lobby	TBD	TBD						
Coastal Landing	TBD	TBD						
ST. CLOUD	29x24x12	696	72	40	22	18	50	115

Capacities shown in this book are maximum for each room, with no staging or audio-visual, and should be used for reference only. Room capacities will be diminished based on your staging and audio-visual needs. Square footage and capacities are based on developer blueprints and are subject to change.



Rendering: Coastal Ballroom



BALLROOMS | LEVEL 2
Citrus Ballroom



Rendering: (Top, Citrus Ballroom) (Left, Rotunda) (Right, Meeting Level Prefunction)

Coastal Breakout Rooms

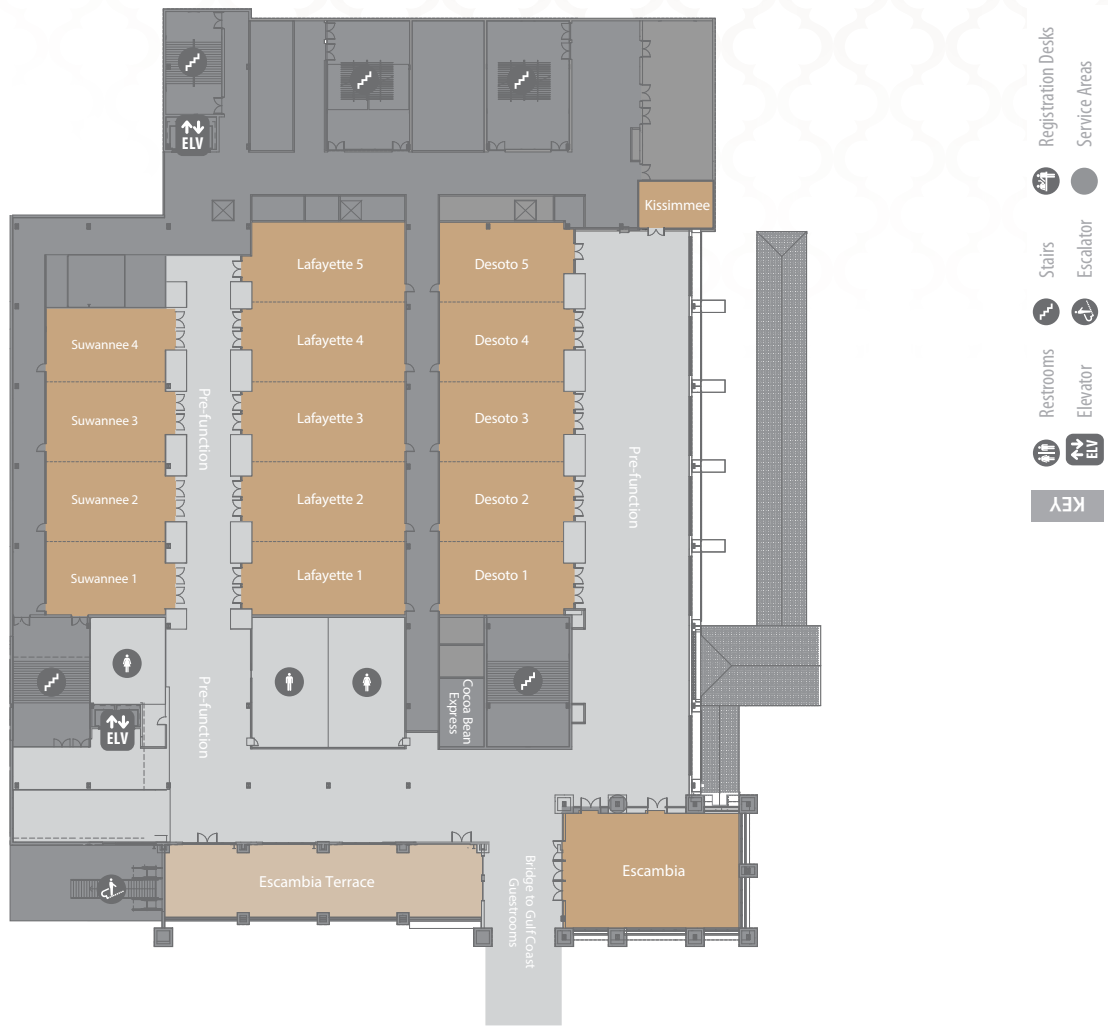

BREAKOUT ROOM	L X W X H (FEET)	SQ.FT.	THEATER	CLASSROOM	CONFERENCE	U-SHAPE	ROUNDS(10)	RECEPTION
DESOTO	150x48x12	7,200	700	480			360	625
1	29x48x12	1,440	140	80	24	26	80	125
2	29x48x12	1,440	140	80	24	26	80	125
3	29x48x12	1,440	140	80	24	26	80	125
4	29x48x12	1,440	140	80	24	26	80	125
5	29x48x12	1,440	140	80	24	26	80	125
LAFAYETTE	150x61x12	9,150	910	600			480	795
1	29x61x12	1,830	182	99	36	34	110	159
2	29x61x12	1,830	182	99	36	34	110	159
3	29x61x12	1,830	182	99	36	34	110	159
4	29x61x12	1,830	182	99	36	34	110	159
5	29x61x12	1,830	182	99	36	34	110	159
SUWANNEE	117x47x12	5,499	560	360			300	478
1	30x47x12	1,374	140	72	28	26	80	119
2	30x47x12	1,374	140	72	28	26	80	119
3	30x47x12	1,374	140	72	28	26	80	119
4	30x47x12	1,374	140	72	28	26	80	119
ESCAMBIA	55x40x12	2,897	286	150	54	69	120	200
Escambia Terrace	110x24	2,640						130
Pre-Function Space		17,642						
KISSIMMEE	30x19x12	570						



Sun & Osceola Breakout Rooms

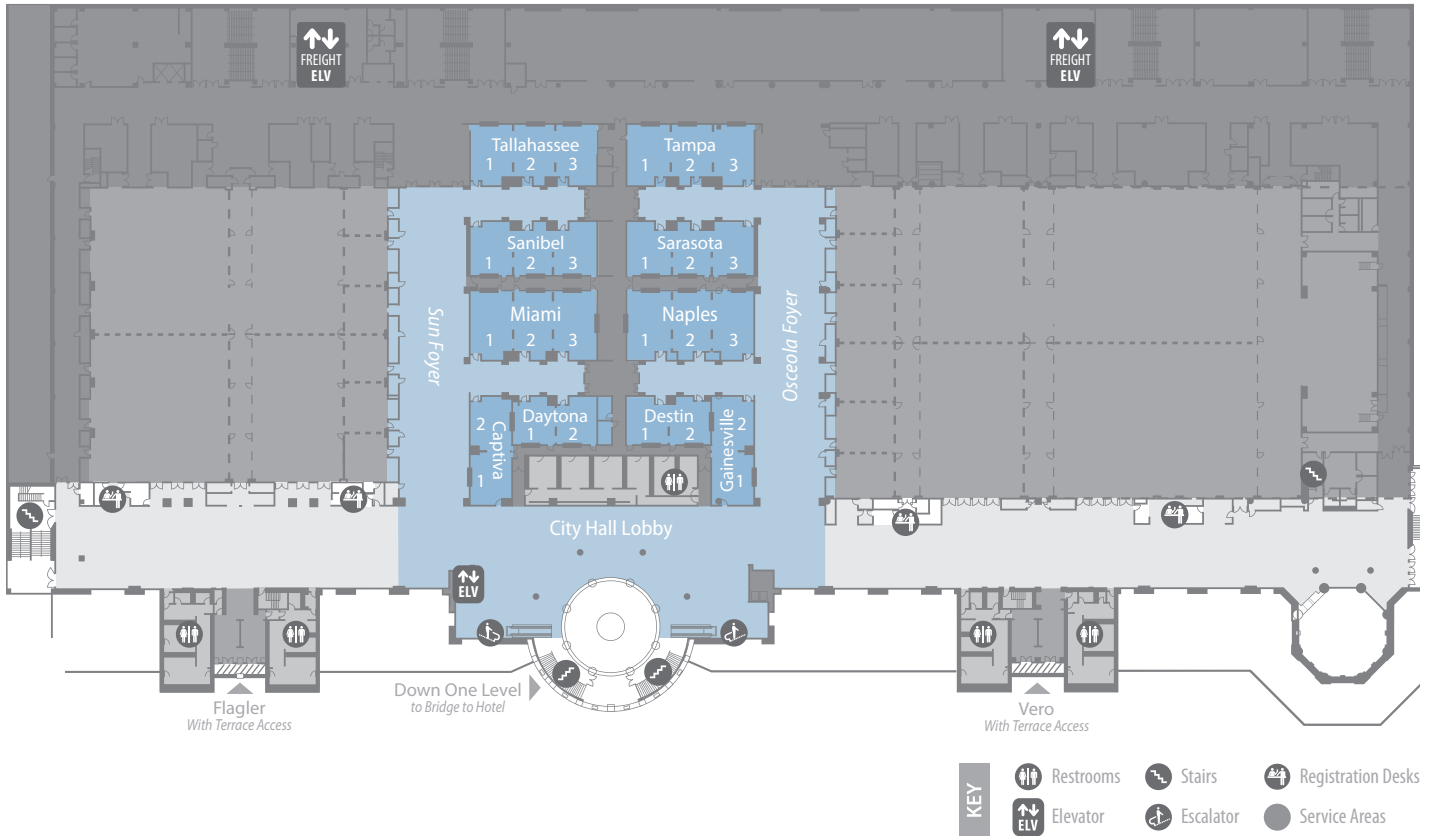
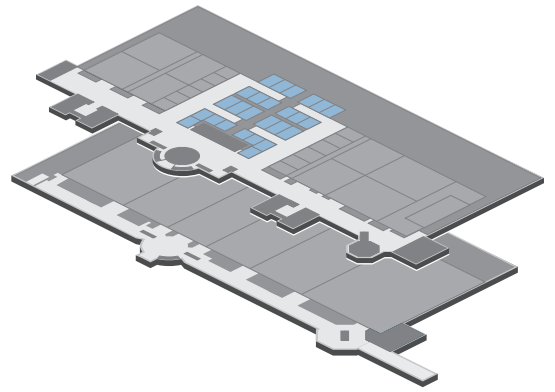

Photograph: Breakout Room

BREAKOUT ROOMS	LXWXH (FEET)	SQ.FT.	THEATER	CLASSROOM	CONFERENCE	U-SHAPE	ROUNDS (10)	RECEPTION
CAPTIVA	61x23x12	1,364	138	88	54	48	90	120
1	30x23x12	676	72	40	30	21	40	60
2	31x23x12	688	72	40	30	21	40	60
DAYTONA	48x27x12	1,194	118	85	48	40	70	105
1	27x24x12	592	59	30	28	20	40	50
2	27x24x12	602	66	36	28	20	30	50
DESTIN	48x27x12	1,186	118	85	48	40	70	105
1	27x24x12	597	66	36	28	20	30	50
2	27x24x12	589	62	30	28	20	40	50
GAINESVILLE	61x23x12	1,361	138	88	54	48	90	120
1	30x23x12	674	72	40	30	21	40	60
2	31x23x12	687	72	40	30	21	40	60
MIAMI	72x39x12	2,626	272	193	84	73	210	230
1	39x24x12	881	104	60	38	29	60	75
2	39x24x12	858	101	60	38	29	60	75
3	39x24x12	887	105	66	38	29	60	75
NAPLES	71x39x12	2,602	272	193	84	73	210	225
1	39x23x12	882	105	66	38	29	60	75
2	39x24x12	848	101	60	38	29	60	75
3	39x24x12	872	104	60	38	29	60	75
SANIBEL	72x30x12	2,023	238	132	76	66	120	175
1	30x24x12	700	84	44	32	24	40	60
2	30x24x12	642	65	40	30	22	40	55
3	30x24x12	681	79	46	30	24	40	60
SARASOTA	71x30x12	2,018	238	132	76	66	120	175
1	30x23x12	674	79	46	30	22	40	60
2	30x24x12	644	65	40	30	22	40	22
3	30x24x12	700	84	44	32	24	40	60
TALLAHASSEE	72x34x12	2,273	249	170	78	69	150	200
1	34x25x12	777	84	50	34	24	50	70
2	34x23x12	699	78	45	34	24	50	60
3	34x24x12	797	98	56	34	24	50	70
TAMPA	70x34x12	2,269	249	170	78	69	150	200
1	34x24x12	794	84	48	34	24	50	70
2	34x22x12	694	78	45	34	24	50	60
3	34x24x12	781	84	50	34	24	50	70
Foyer & Lobbies								
Sun Foyer		8,902						
Osceola Foyer		8,933						
City Hall Lobby		9,772						

Capacities shown in this book are maximum for each room, with no staging or audio-visual, and should be used for reference only. Room capacities will be diminished based on your staging and audio-visual needs.

Florida Exhibition Hall

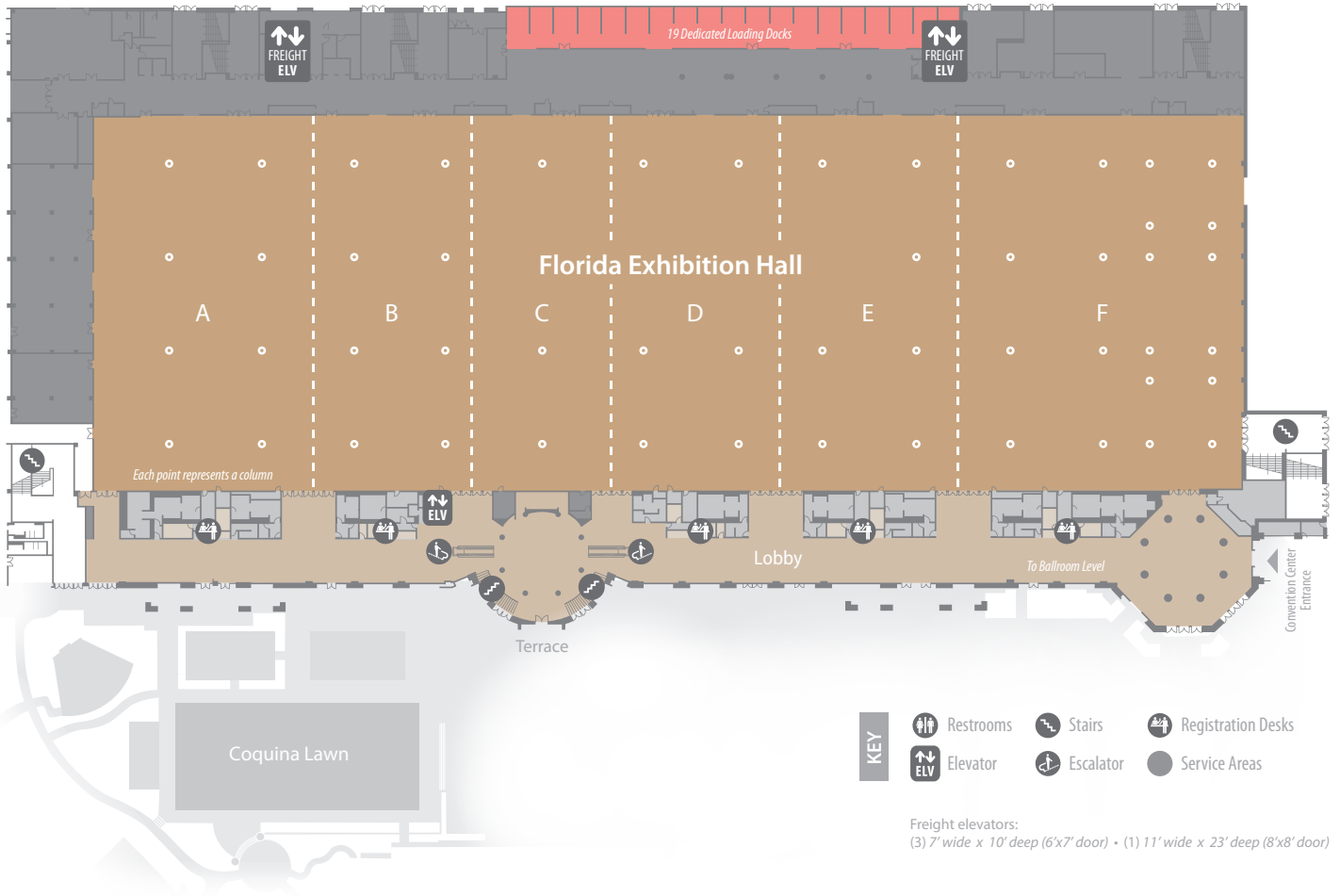
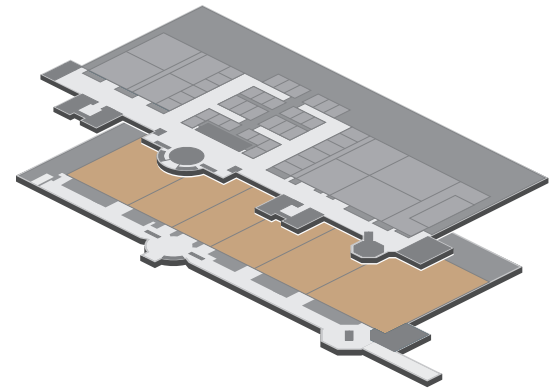

EXHIBITION HALL	L X W X H (FEET)	SQ. FT.	THEATER	CLASSROOM	MODULAR BREAKOUTS	ROUNDS (10)	RECEPTION	8 X 10 BOOTHS	10 X 10 BOOTHS
FLORIDA	740x241x24	178,500	21,326	12,792	173	11,928	14,770	1,116	893
A	241x142x24	34,300	4,276	2,568	34	2,328	2,860	214	172
B	241x102x24	24,570	2,725	1,653	23	1,620	2,020	154	123
C	241x90x24	21,700	2,746	1,419	22	1,400	1,850	136	109
D	241x102x24	24,570	2,725	1,653	23	1,620	2,020	154	123
E	241x120x24	29,000	3,444	2,181	28	1,972	2,440	181	145
F	241x184x24	44,360	5,410	3,318	43	2,988	3,580	277	222
Pre-Function Space		31,800							
10 Offices									
5 Registration Desks									

Capacities shown in this book are maximum for each room, with no staging or audio-visual, and should be used for reference only. Room capacities will be diminished based on your staging and audio-visual needs.

Palm Beach Meeting Room & Orange Blossom Ballroom

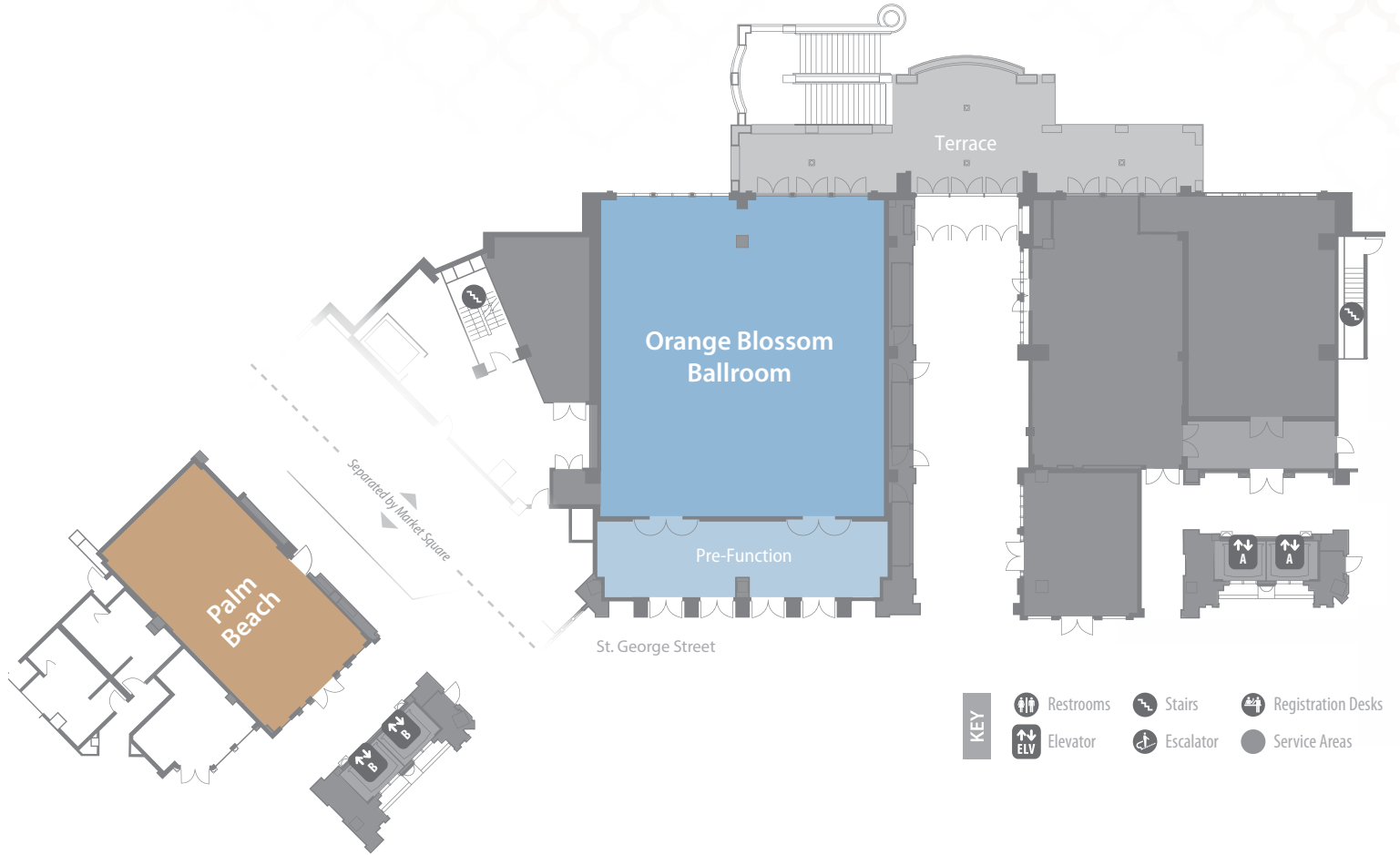

MEETING ROOM	LXWXH (FEET)	SQ.FT.	THEATER	CLASSROOM	CONFERENCEE	U-SHAPE	ROUNDS (10)	RECEPTION
PALM BEACH	48x27x10	1,296	124	78	42	34	60	100

BALLROOM	LXWXH (FEET)	SQ.FT.	THEATER	CLASSROOM	CONFERENCE	U-SHAPE	ROUNDS (10)	RECEPTION
ORANGE BLOSSOM	59x53x12	3,115	312	189	82	59	240	270
Pre-Function	54x13x12	700						

Capacities shown in this book are maximum for each room, with no staging or audio-visual, and should be used for reference only. Room capacities will be diminished based on your staging and audio-visual needs.

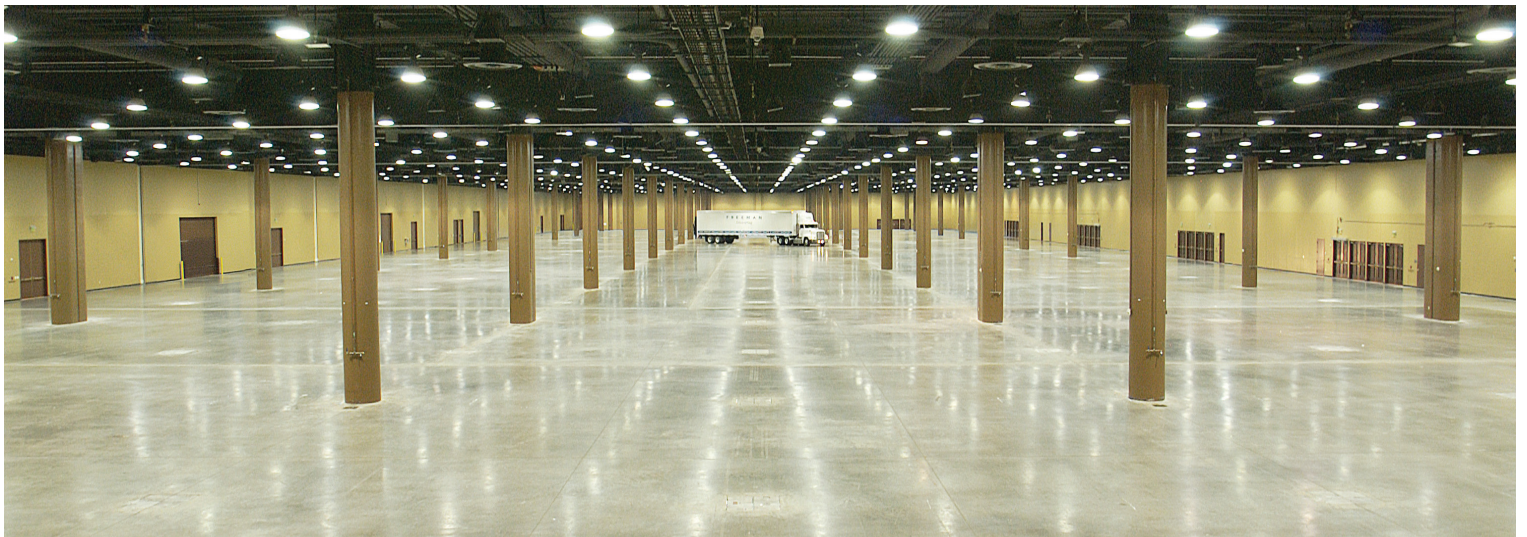

Photograph: Florida Exhibition Hall

St. George Meeting Rooms



Photograph: St. George Meeting Room



MEETING ROOMS	LXWXH (FEET)	SQ.FT.	THEATER	CLASSROOM	CONFERENCE	U-SHAPE	ROUNDS (10)	RECEPTION
ST. GEORGE								
102	35x22x10	752	72	39	28	20	40	65
104	43x31x10	1,231	100	49	42	34	60	105
106	32x27x10	834	94	55	34	36	60	70
108	49x27x10	1,269	168	90	52	42	80	110
112	38x25x10	950	112	54	36	32	60	80
114	44x30x10	1,320	140	90	42	44	70	90
Pre-Function Space								
110 (Office)								

Capacities shown in this book are maximum for each room, with no staging or audio-visual, and should be used for reference only. Room capacities will be diminished based on your staging and audio-visual needs.

Emerald Bay Meeting Rooms

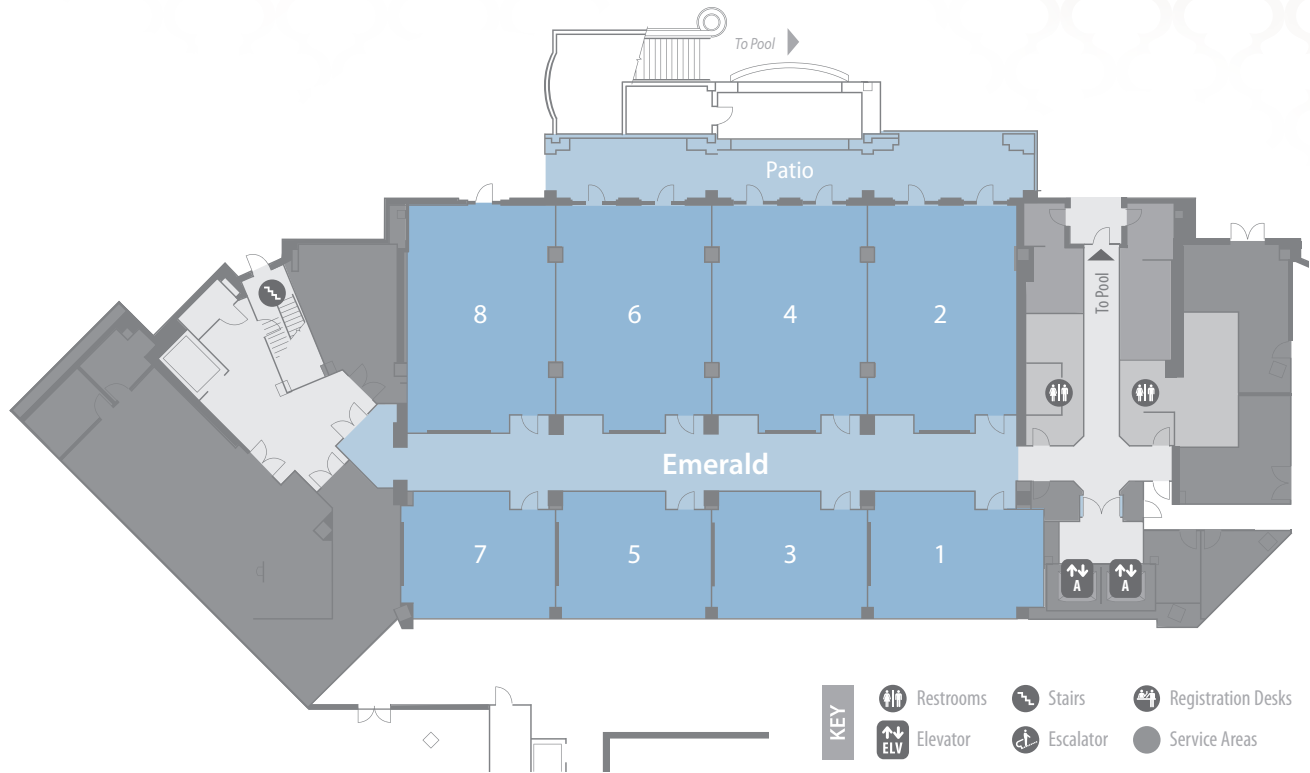

MEETING ROOMS	L X W X H (FEET)	SQ.FT.	THEATER	CLASSROOM	CONFERENCE	U-SHAPE	ROUNDS (10)	RECEPTION
EMERALD BAY								
1	31x22x9	636	65	39	30	22	40	55
2	41x26x9	1,021	114	64	44	36	60	90
3	27x22x9	574	49	32	30	22	40	50
4	41x27x9	1,058	110	64	44	36	60	90
5	27x22x9	573	49	32	30	22	40	50
6	41x27x9	1,061	110	64	44	36	60	90
7	27x22x9	566	49	32	30	22	40	50
8	41x26x9	1,034	115	63	44	36	60	90

Capacities shown in this book are maximum for each room, with no staging or audio-visual, and should be used for reference only. Room capacities will be diminished based on your staging and audio-visual needs.



Photograph: Emerald Bay Room

Executive Center

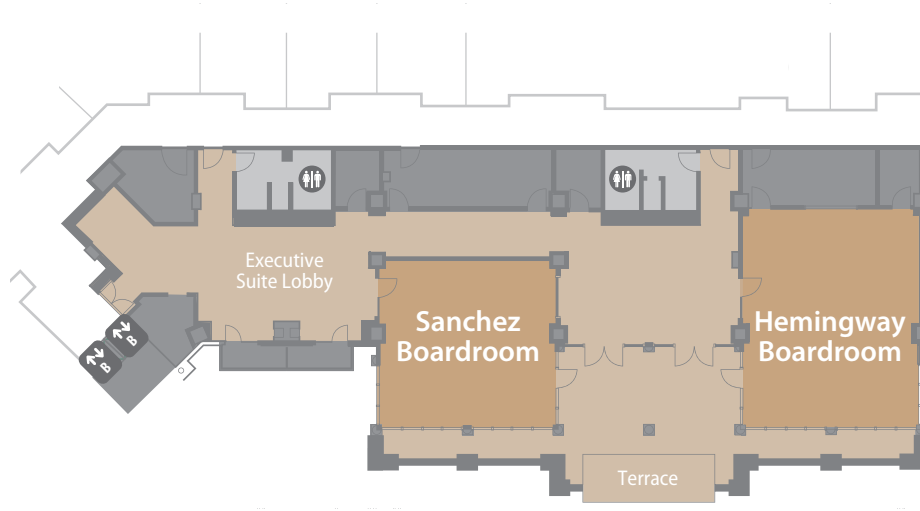

BOARDROOMS	L X W X H (FEET)	SQ.FT.	BOARDROOM TABLE
EMERALD BAY			
Executive Center (with Terrace)		2,789	
Executive Center (without Terrace)		2,341	
Sanchez	27x25x12	678	12 ppl
Hemingway	33x28x12	912	14 ppl

KEY

- Restrooms
- Stairs
- Registration Desks
- Elevator
- Escalator
- Service Areas

Capacities shown in this book are maximum for each room, with no staging or audio-visual, and should be used for reference only. Room capacities will be diminished based on your staging and audio-visual needs.



Photograph: Hemingway Boardroom



ATRIUM FLEX-SPACE	SQ.FT.	ROUNDS (10)	RECEPTION (STANDING)
ST. AUGUSTINE	7,000	700	1,800
Castillo de San Marcos Fort	5,500	170	350
Upper Level	2,300	50	150
Lower Level	3,200	120	200
Emerald Bay Plaza	8,532	400	550
Wedding Pavillion	1,100	30	60

ATRIUM FLEX-SPACE	RECEPTION
KEY WEST	
Atrium Buyout (with MOOR)	600



Photographs: (Top, Castillo de San Marcos Fort) (Bottom, Emerald Plaza)



FLEX-SPACE | OUTDOOR
Coquina Lawn



OUTDOOR FLEX-SPACE	L X W (FEET)	SQ.FT.	THEATER	ROUNDS (10)	RECEPTION
COQUINA LAWN		16,176	1,000	750	1,260
Grass Area	162x80	8,845	1,000	600	1,100
Concrete Surround		5,171			
Fire Pit 1	36x36	1,296		60	60
Fire Pit 2	50x20	1,000		50	50
Fire Pit 3	50x20	1,000		50	50

Capacities shown in this book are maximum for each room, with no staging or audio-visual, and should be used for reference only. Room capacities will be diminished based on your staging and audio-visual needs.

Photographs: (Top & Bottom, Coquina Lawn)



OUTDOOR FLEX-SPACE	L X W (FEET)	SQ.FT.	THEATER	ROUNDS (10)	RECEPTION
MANGROVE LAWN		19,773			
Grass Area		9,906			
Concrete Surround		3,722			
Fire Pit 1		292			
Fire Pit 2		352			
Mangrove Patio		5,501			

Capacities shown in this book are maximum for each room, with no staging or audio-visual, and should be used for reference only. Room capacities will be diminished based on your staging and audio-visual needs.



Renderings: (Top & Bottom, Mangrove Lawn)



MOOR



RESTAURANT FLEX-SPACE

	SEATED CAPACITY	RECEPTION
MOOR	276	400
Sailboat	60	65
Mooring	40	40
Yawl	40	40
Schooner	48	55
Ketch	28	35
Rooftop Terrace	40	75
Lounge	20	50

Capacities shown in this book are maximum for each room, with no staging or audio-visual, and should be used for reference only. Room capacities will be diminished based on your staging and audio-visual needs.

Photographs: (Top, MOOR; Bottom, MOOR Dining)

Old Hickory Steakhouse



RESTAURANT FLEX-SPACE	SEATED CAPACITY	RECEPTION
OLD HICKORY STEAKHOUSE	220	250
Mango Grove Cabin & Patio	100	120
Mango Grove Patio	60	60
Aunt Lillie's Cabin	20	25
Aunt Lillie's Patio	30	30
Cypress Springs Dining Room	40	40

Capacities shown in this book are maximum for each room, with no staging or audio-visual, and should be used for reference only. Room capacities will be diminished based on your staging and audio-visual needs.



Photographs: (Top, Old Hickory Steakhouse; Bottom, Old Hickory Steakhouse Exterior)



FLEX-SPACE | RESTAURANT

Wreckers Sports Bar



RESTAURANT FLEX-SPACE

	SEATED CAPACITY	RECEPTION
WRECKERS SPORTS BAR	400	700
Lower Level	276	500
South Patio	50	60
Centerfield	100	120
Floor Seating	50	60
North Patio	60	75
Rum Barrels	16	20
Upper Level	124	200
East	16	20
West	16	20
Sky Box	32	
The Veranda	60	75

Capacities shown in this book are maximum for each room, with no staging or audio-visual, and should be used for reference only. Room capacities will be diminished based on your staging and audio-visual needs.

Villa de Flora & Socio

RESTAURANT FLEX-SPACE	SEATED CAPACITY	RECEPTION
VILLA DE FLORA	410	450
Olea	35	45
Atrio (without Patio/Artisan Pizza Area)	164	190
Atrio (with Patio/Artisan Pizza Area)	200	
Cenare	60	75
Veranda	90	115

Capacities shown in this book are maximum for each room, with no staging or audio-visual, and should be used for reference only. Room capacities will be diminished based on your staging and audio-visual needs.



RESTAURANT FLEX-SPACE	RECEPTION
SOCIO	125
Sol Room	35
Cielo Room	35
Sol y Cielo	70

Capacities shown in this book are maximum for each room, with no staging or audio-visual, and should be used for reference only. Room capacities will be diminished based on your staging and audio-visual needs.



Photographs: (Top Left, Villa de Flora Patio; Top Right, Villa de Flora; Bottom Left, Socio; Bottom Right, Socio Patio)



FLEX-SPACE | ROOMS

Convertible Guest Rooms/Hospitality Suites



Sometimes creativity and conversation call for a more intimate environment. Our contemporary convertible Hospitality Suites are personalized, encouraging collaboration in a comfortable environment; and our Deluxe Suites boast the modern conveniences of your own home with plenty of working and networking space.

ROOMS FLEX-SPACE	SQ. FT.	ROUNDS	BOARDROOM TABLE
CONVERTIBLE GUEST ROOMS			
Hospitality Suites	343-420	N/A	8
Deluxe Suites (8-chair)	831	20	8

Photographs: (Top, Hospitality Suite; Bottom, Deluxe Suite)